

TYPICAL KEY PLAN

Atlantic Ocean View

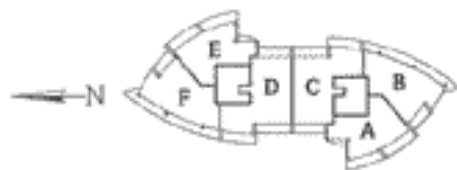

Tomberry Golf Course View

UNIT F Approx. Square

3 BEDROOMS • 4 1/2 BATHS		
INTERIOR	2,896 Sq. Ft.	268 M ²
TERRACE	842 Sq. Ft.	78 M ²
TOTAL RESIDENCE	3,738 Sq. Ft.	344 M²

Note: All dimensions are approximate. Plans, schedules and specifications are subject to modification and other conditions at the sole discretion of the developer, builder or architect, or to may be required by the local, state or federal government or any particular bank. Final representations correct for sales use are correct sales representations of the developer. For correct representations make reference to this set and to the documents required to obtain 148,000 Florida dollars to be loaned by developer to buyer or leasee.