



Residence A

4 bedrooms
5 bathrooms
1 powder room

Interior
3,712 SF - 344.9 SQM

Exterior
941 SF - 87.4 SQM
734 SF - 68.2 SQM

8A
\$9,560,000

39A
\$11,060,000

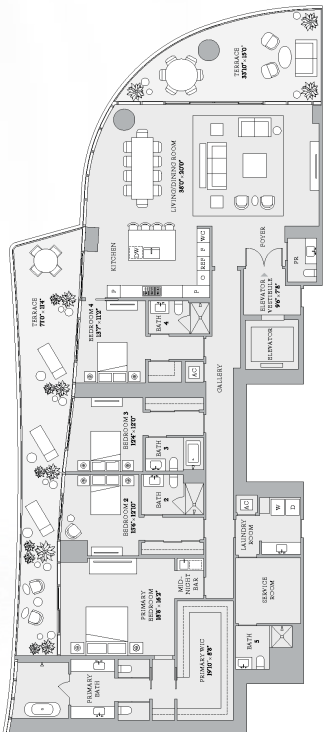

Residence B

4 bedrooms
5 bathrooms
1 powder room

Interior
3,679 SF - 341.8 SQM

Exterior
941 SF - 87.4 SQM

8B
\$7,740,000

17B
\$7,850,000

26B
\$8,990,000

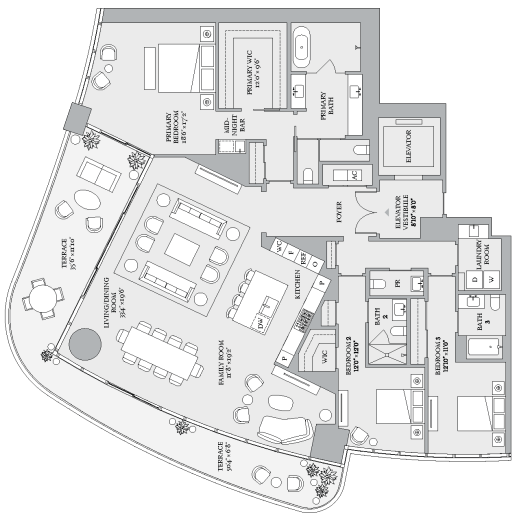
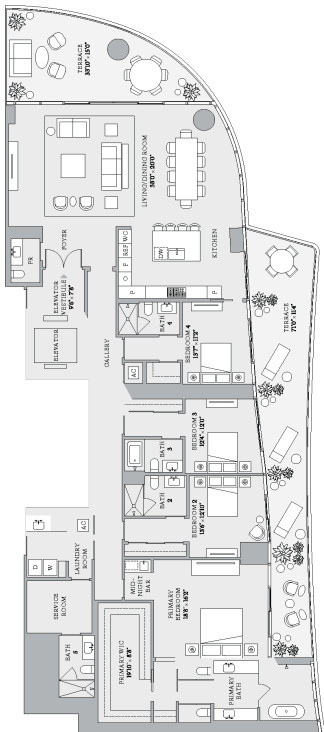

Residence C

3 bedrooms
3 bathrooms
1 powder room

Interior
2,987 SF - 277.5 SQM

Exterior
590 SF - 54.8 SQM

26C
\$6,065,000

36C
\$6,665,000

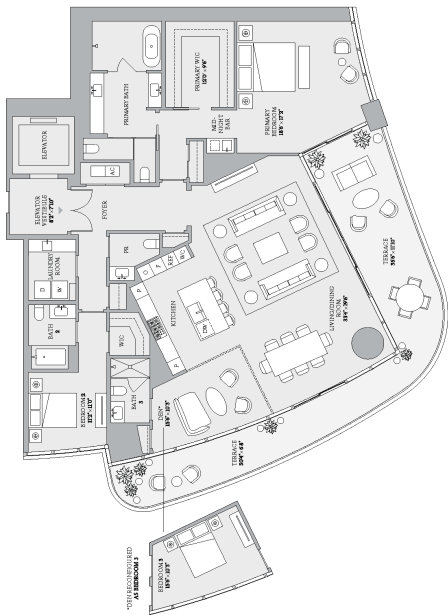

Residence D

2 bedrooms
3 bathrooms
1 powder room + den

Interior
2,616 SF - 243 SQM

Exterior
590 SF - 54.8 SQM

25D
\$5,145,000.

33D
\$5,345,000

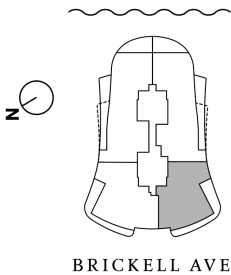

*Pricing and availability are subject to change without notice