

# RIVAGE

BAL HARBOUR

LOWER PENTHOUSE FLOORS  
**A 22, 24**

6 BEDROOMS  
 9 BATHROOMS  
 2 POWDER ROOMS  
 DEN  
 SERVICE  
 FAMILY ROOM

SKY ROOM  
 WINE ROOM  
 OUTDOOR KITCHEN  
 SPA POOL  
 PRIVATE ELEVATOR

INTERIOR  
 9,464 SF | 879 SQM  
 EXTERIOR  
 1,346 SF | 125 SQM

TOTAL  
 10,810 SF | 1,004 SQM

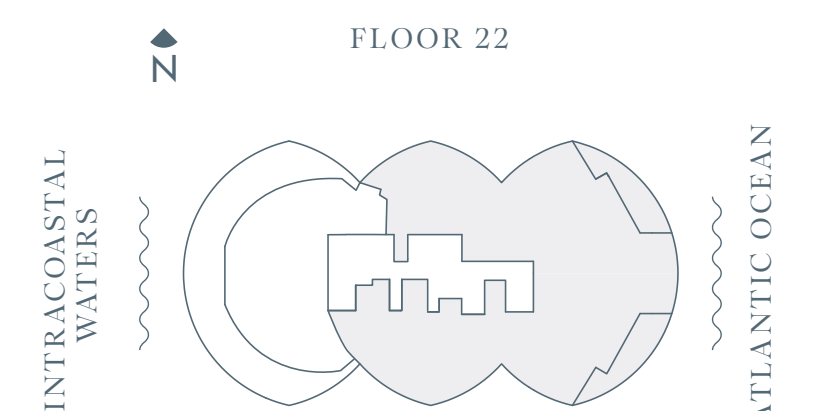
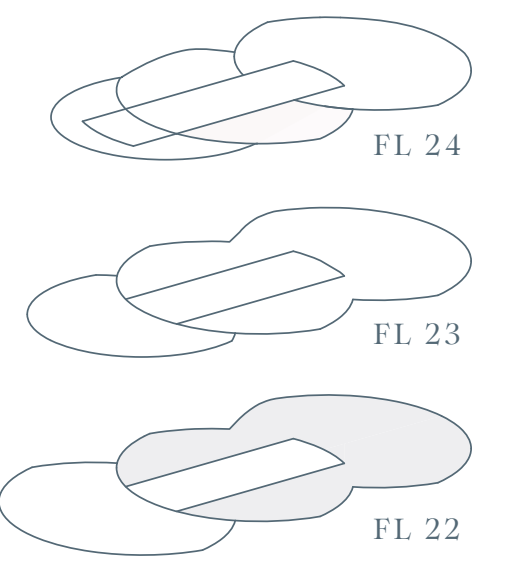

The dimensions stated for any depicted Unit floor plan are approximate because there are various recognized methods for calculating the square footage of a Unit. The square footage stated herein is calculated from the exterior boundaries of the exterior walls to the centerline of interior demising walls without deductions for cutouts, curves, or architectural features. This method typically results in quoted dimensions greater than the dimensions that would be determined by using other accepted methods. The floor plan, unit layout, locations of windows, doors, closets, plumbing fixtures, mechanical equipment, appliances, structural elements, architectural design elements, and the uses, configurations, and entries to rooms may change based on final approved plans, permitting, and completed construction. The furniture layout and the uses of space illustrated are suggested uses only and not intended to guarantee any specific use of space or accommodation of specific furnishings. Consult the Developer's Prospectus to learn what is included with a Unit purchase and to review the Unit square footage calculation method to be relied upon. 30230 Carlton Terrace Owner LLC, with all rights reserved.

# RIVAGE

BAL HARBOUR

LOWER PENTHOUSE FLOORS  
**A 22, 24**

6 BEDROOMS  
9 BATHROOMS  
2 POWDER ROOMS  
DEN  
SERVICE  
FAMILY ROOM

SKY ROOM  
WINE ROOM  
OUTDOOR KITCHEN  
SPA POOL  
PRIVATE ELEVATOR

INTERIOR  
9,464 SF | 879 SQM  
EXTERIOR  
1,346 SF | 125 SQM

TOTAL  
10,810 SF | 1,004 SQM

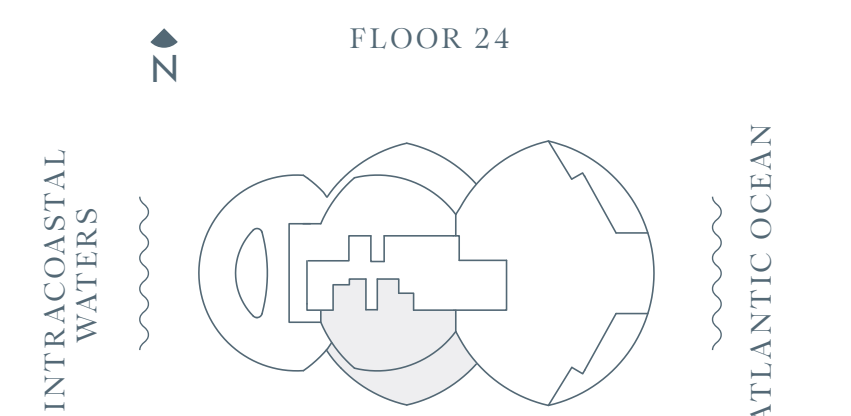
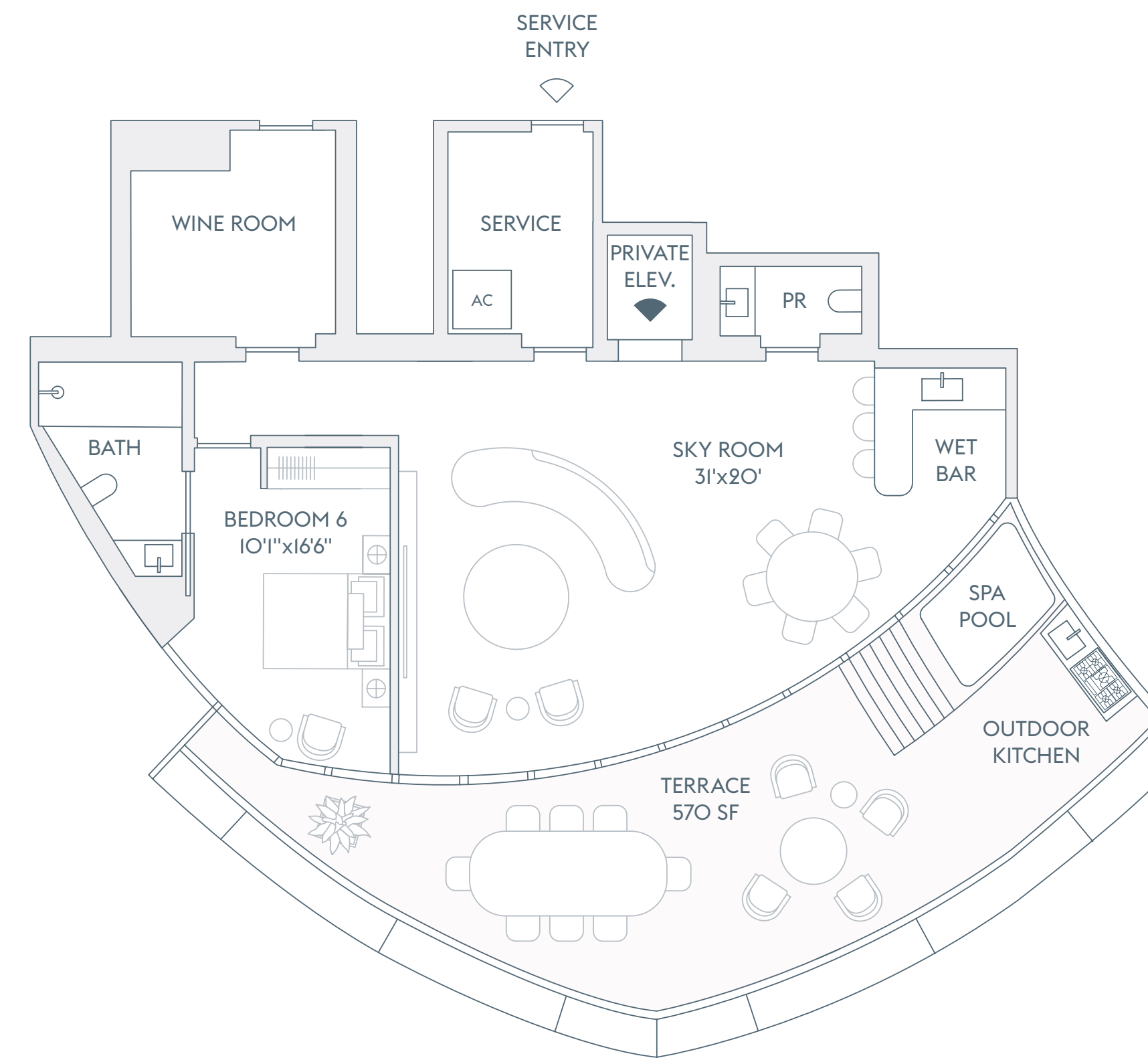
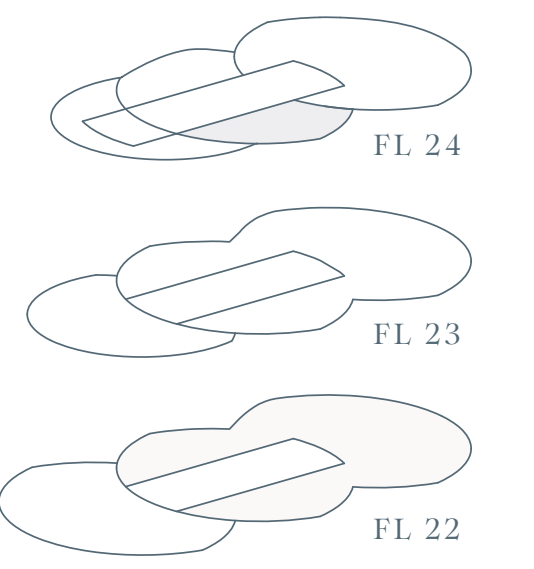

The dimensions stated for any depicted Unit floor plan are approximate because there are various recognized methods for calculating the square footage of a Unit. The square footage stated herein is calculated from the exterior boundaries of the exterior walls to the centerline of interior demising walls without deductions for cutouts, curves, or architectural features. This method typically results in quoted dimensions greater than the dimensions that would be determined by using other accepted methods. The floor plan, Unit layout, locations of windows, doors, closets, plumbing fixtures, mechanical equipment, appliances, structural elements, architectural design elements, and the uses, configurations, and entries to rooms may change based on final approved plans, permitting, and completed construction. The furniture layout and the uses of space illustrated are suggested uses only and not intended to guarantee any specific use of space or accommodation of specific furnishings. Consult the Developer's Prospectus to learn what is included with a Unit purchase and to review the Unit square footage calculation method to be relied upon. 3023D Carlton Terrace Owner LLC, with all rights reserved.

# RIVAGE

BAL HARBOUR

OCEAN PENTHOUSE FLOORS  
**A 23, 24, 25**

5 BEDROOMS  
 7 BATHROOMS  
 3 POWDER ROOMS  
 DEN / SERVICE  
 MEDIA ROOM  
 GAME ROOM

LIBRARY / LOUNGE  
 FITNESS STUDIO  
 OUTDOOR KITCHEN  
 POOL  
 PRIVATE ELEVATOR

INTERIOR  
 12,603 SF | 1,171 SQM  
 EXTERIOR  
 4,918 SF | 457 SQM

TOTAL  
 17,521 SF | 1,628 SQM

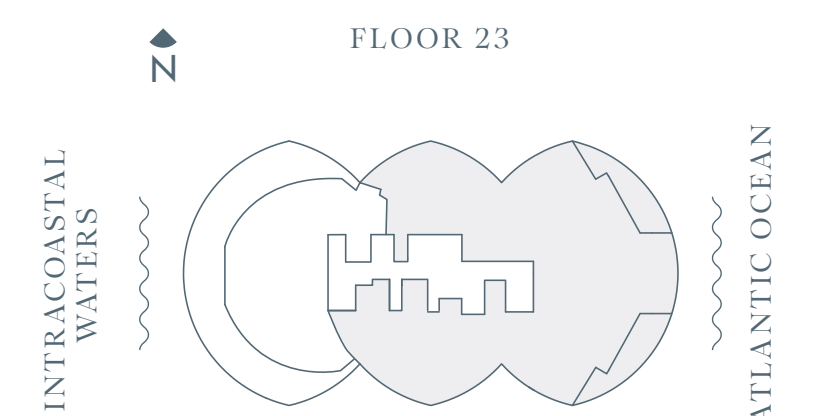
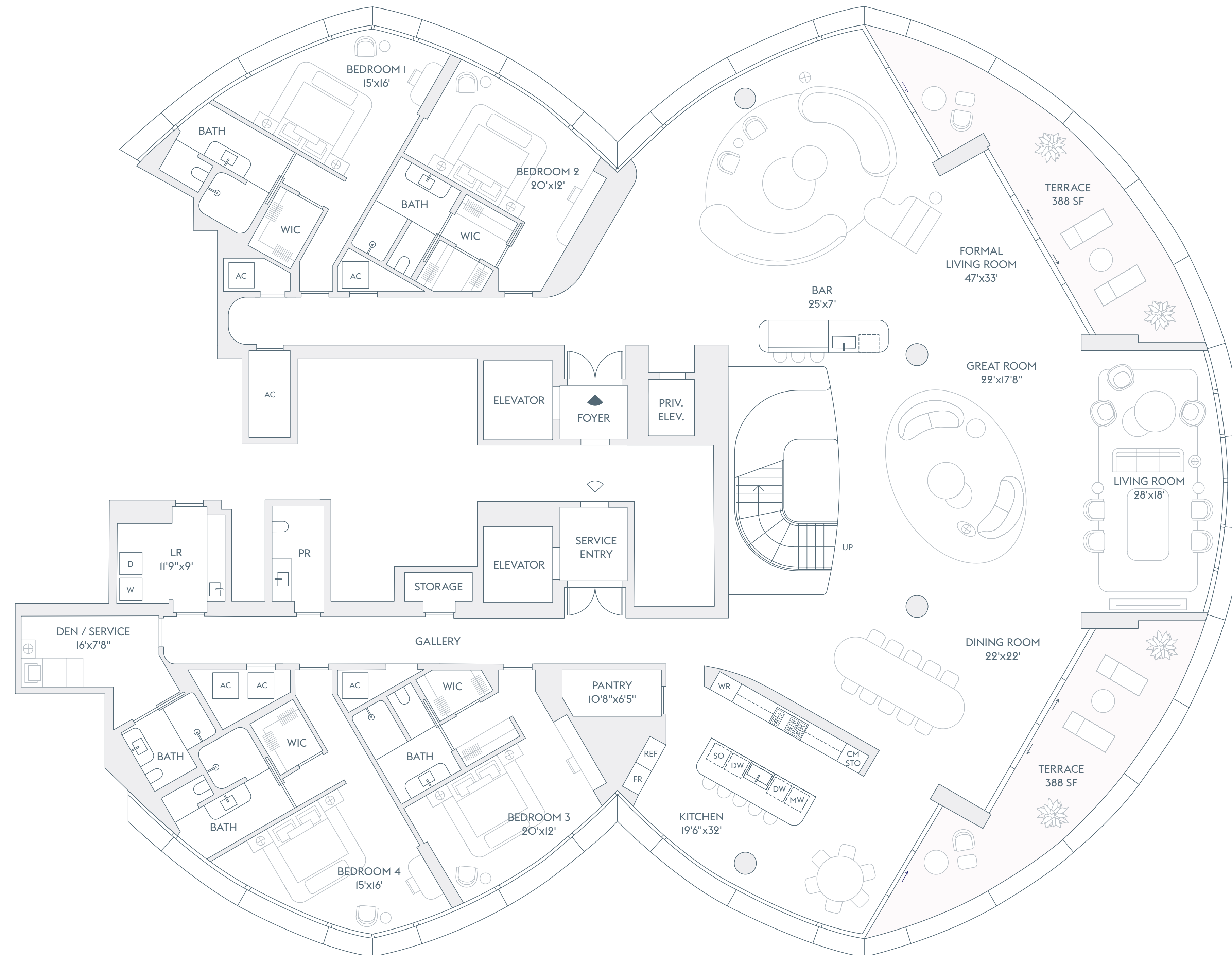
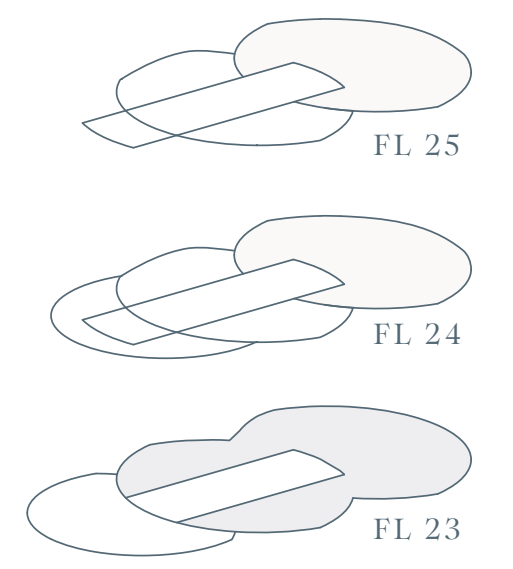

The dimensions stated for any depicted Unit floor plan are approximate because there are various recognized methods for calculating the square footage of a Unit. The square footage stated herein is calculated from the exterior boundaries of the exterior walls to the centerline of interior demising walls without deductions for cutouts, curves, or architectural features. This method typically results in quoted dimensions greater than the dimensions that would be determined by using other accepted methods. The floor plan, Unit layout, locations of windows, doors, closets, plumbing fixtures, mechanical equipment, appliances, structural elements, architectural design elements, and the uses, configurations, and entries to rooms may change based on final approved plans, permitting, and completed construction. The furniture layout and the uses of space illustrated are suggested uses only and not intended to guarantee any specific use of space or accommodation of specific furnishings. Consult the Developer's Prospectus to learn what is included with a Unit purchase and to review the Unit square footage calculation method to be relied upon. ©2020 Carlton Terrace Owner LLC, with all rights reserved.

# RIVAGE

BAL HARBOUR

OCEAN  
PENTHOUSE

FLOORS

# A 23, 24, 25

5 BEDROOMS  
7 BATHROOMS  
3 POWDER ROOMS  
DEN / SERVICE  
MEDIA ROOM  
GAME ROOM

LIBRARY / LOUNGE  
FITNESS STUDIO  
OUTDOOR KITCHEN  
POOL  
PRIVATE ELEVATOR

INTERIOR  
12,603 SF | 1,171 SQM  
  
EXTERIOR  
4,918 SF | 457 SQM

TOTAL  
17,521 SF | 1,628 SQM

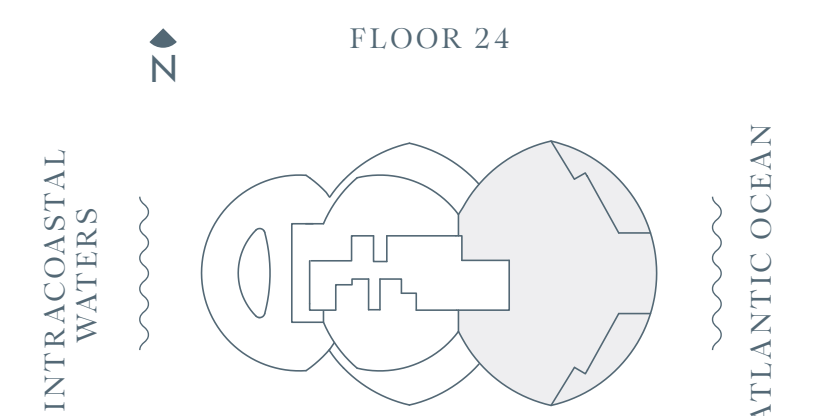
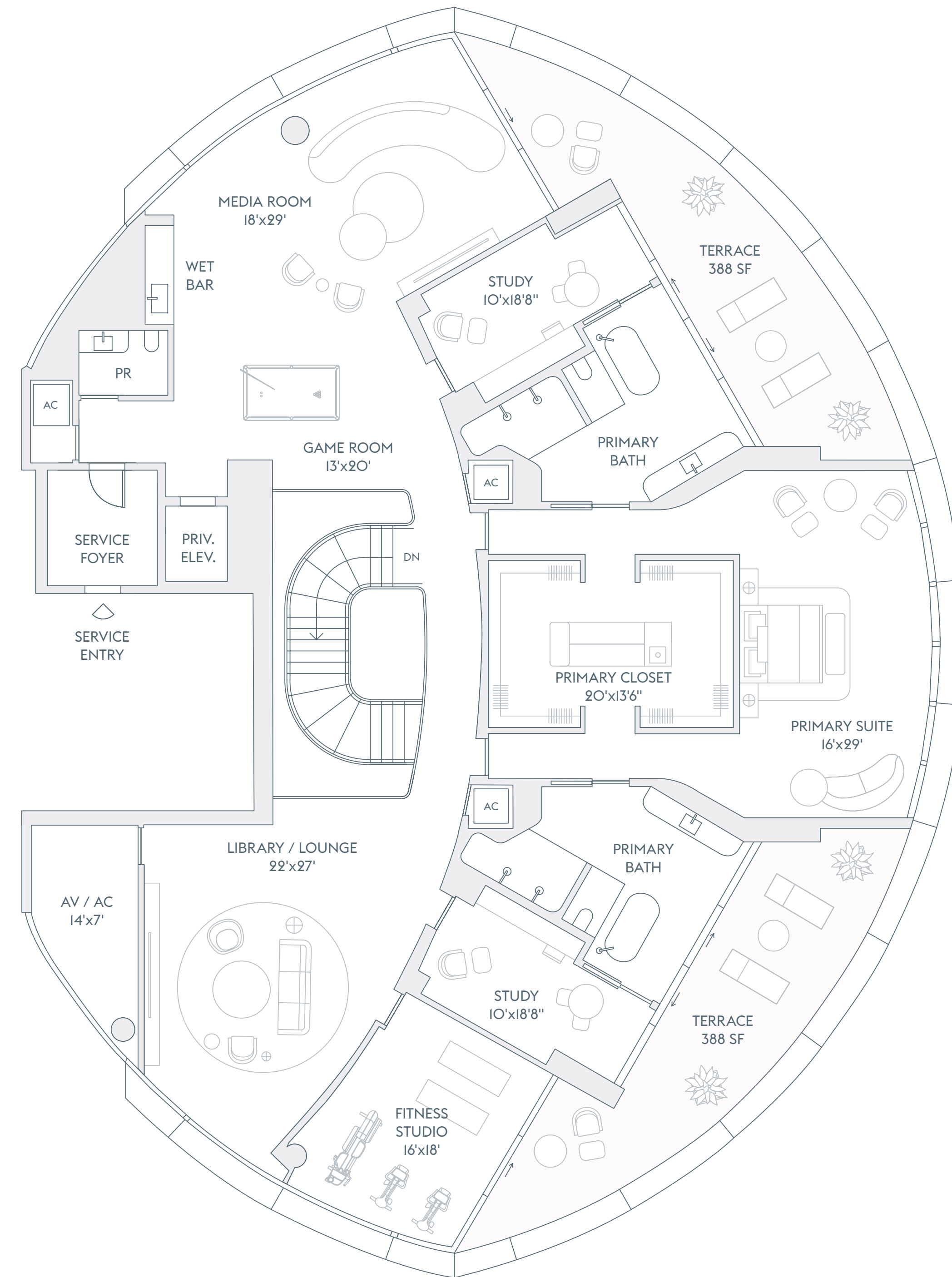
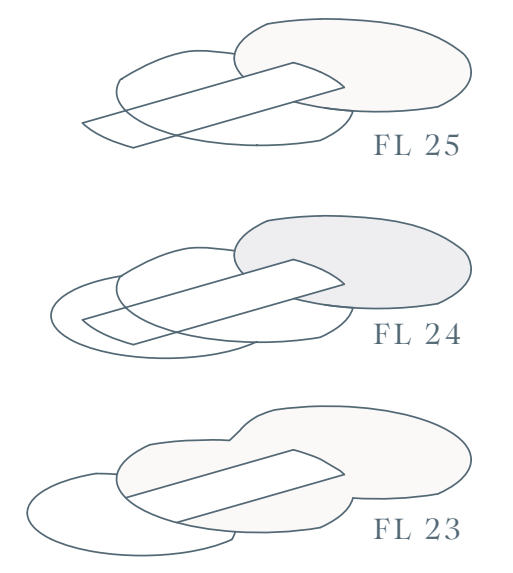

The dimensions stated for any depicted Unit floor plan are approximate because there are various recognized methods for calculating the square footage of a Unit. The square footage stated herein is calculated from the exterior boundaries of the exterior walls to the centerline of interior demising walls without deductions for cutouts, curves, or architectural features. This method typically results in quoted dimensions greater than the dimensions that would be determined by using other accepted methods. The floor plan, Unit layout, locations of windows, doors, closets, plumbing fixtures, mechanical equipment, appliances, structural elements, architectural design elements, and the uses, configurations, and entries to rooms may change based on final approved plans, permitting, and completed construction. The furniture layout and the uses of space illustrated are suggested uses only and not intended to guarantee any specific use of space or accommodation of specific furnishings. Consult the Developer's Prospectus to learn what is included with a Unit purchase and to review the Unit square footage calculation method to be relied upon. 2023D Carlton Terrace Owner LLC, with all rights reserved.

# RIVAGE

BAL HARBOUR

OCEAN  
PENTHOUSE

FLOORS

# A 23, 24, 25

5 BEDROOMS  
7 BATHROOMS  
3 POWDER ROOMS  
DEN / SERVICE  
MEDIA ROOM  
GAME ROOM

LIBRARY / LOUNGE  
FITNESS STUDIO  
OUTDOOR KITCHEN  
POOL  
PRIVATE ELEVATOR

INTERIOR  
12,603 SF | 1,171 SQM  
EXTERIOR  
4,918 SF | 457 SQM

TOTAL  
17,521 SF | 1,628 SQM

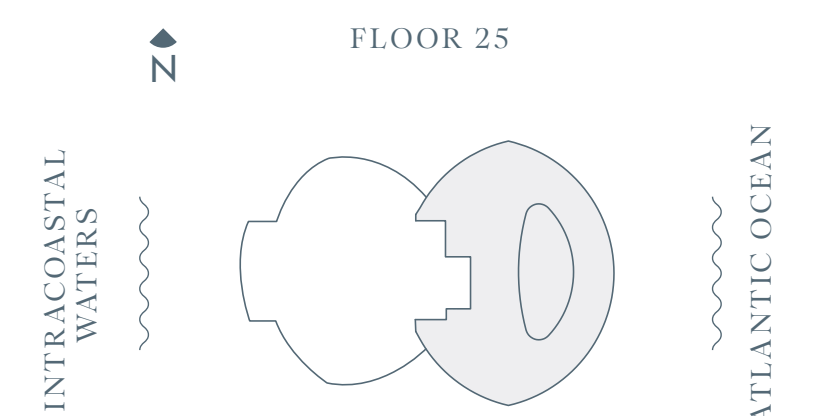
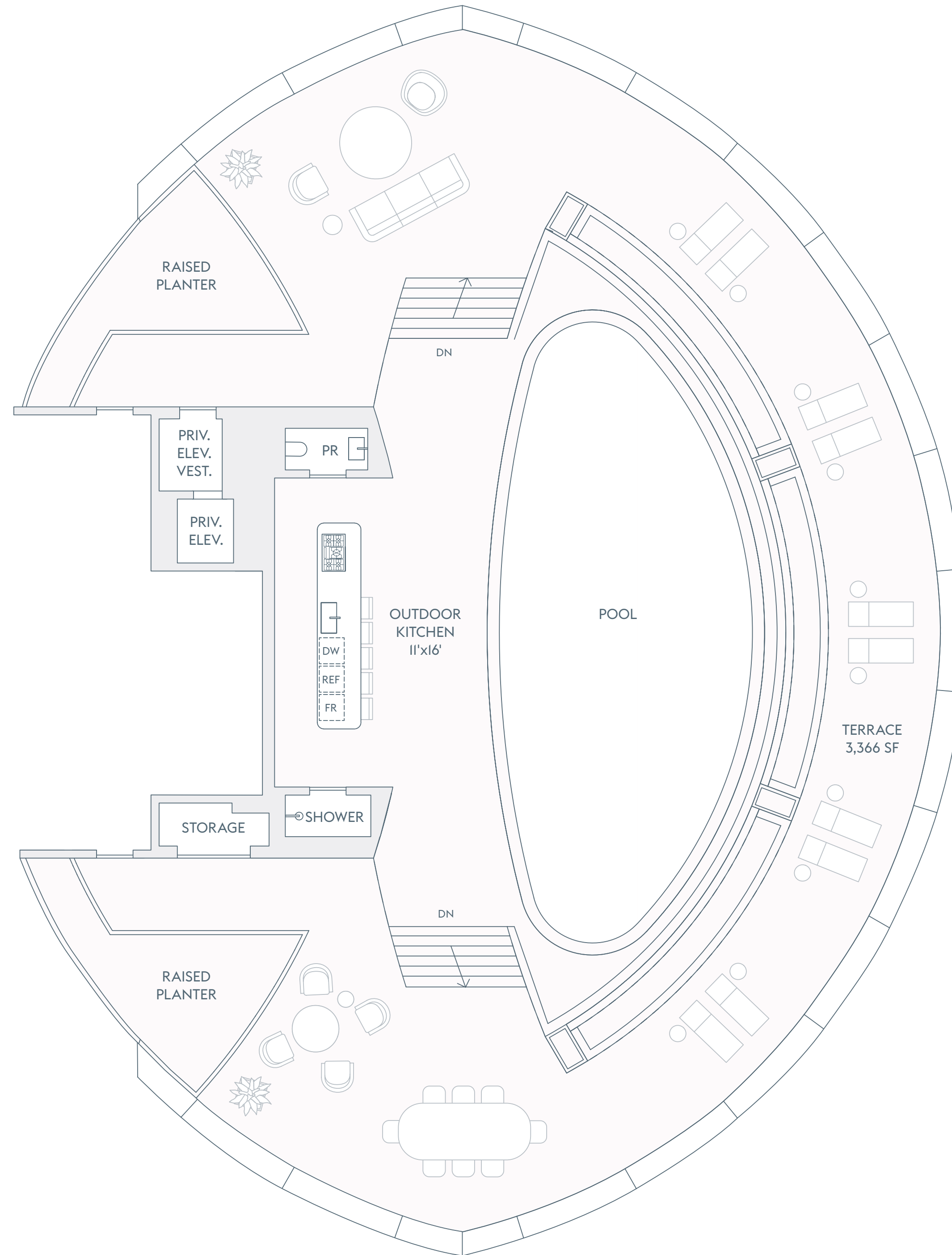
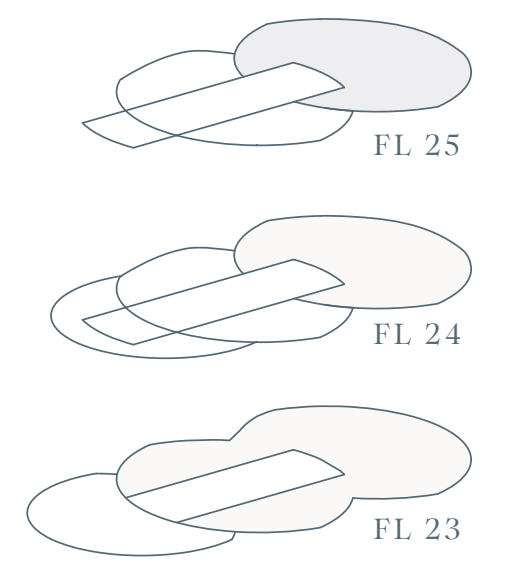

The dimensions stated for any depicted Unit floor plan are approximate because there are various recognized methods for calculating the square footage of a Unit. The square footage stated herein is calculated from the exterior boundaries of the exterior walls to the centerline of interior demising walls without deductions for cutouts, curves, or architectural features. This method typically results in quoted dimensions greater than the dimensions that would be determined by using other accepted methods. The floor plan, Unit layout, locations of windows, doors, closets, plumbing fixtures, mechanical equipment, appliances, structural elements, architectural design elements, and the uses, configurations, and entries to rooms may change based on final approved plans, permitting, and completed construction. The furniture layout and the uses of space illustrated are suggested uses only and not intended to guarantee any specific use of space or accommodation of specific furnishings. Consult the Developer's Prospectus to learn what is included with a Unit purchase and to review the Unit square footage calculation method to be relied upon. 3023D Carlton Terrace Owner LLC, with all rights reserved.

# RIVAGE

BAL HARBOUR

RESIDENCE  
**A**

FLOORS  
**3-17**

4 BEDROOMS  
5 BATHROOMS  
POWDER ROOM  
DEN / SERVICE

INTERIOR  
4,810 SF | 447 SQM

EXTERIOR  
388 SF | 36 SQM

TOTAL  
5,198 SF | 483 SQM

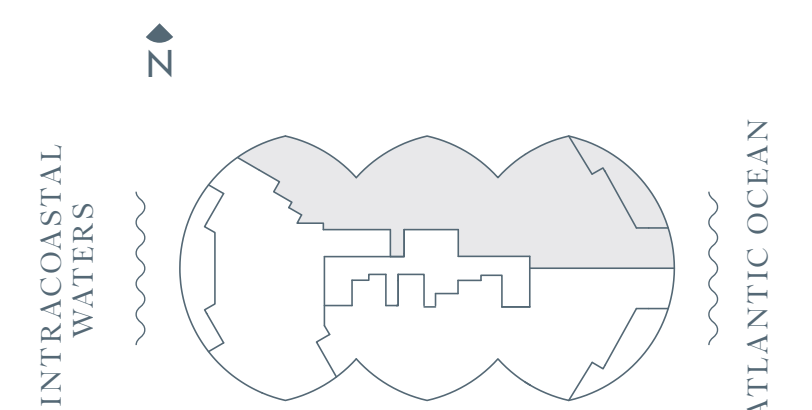
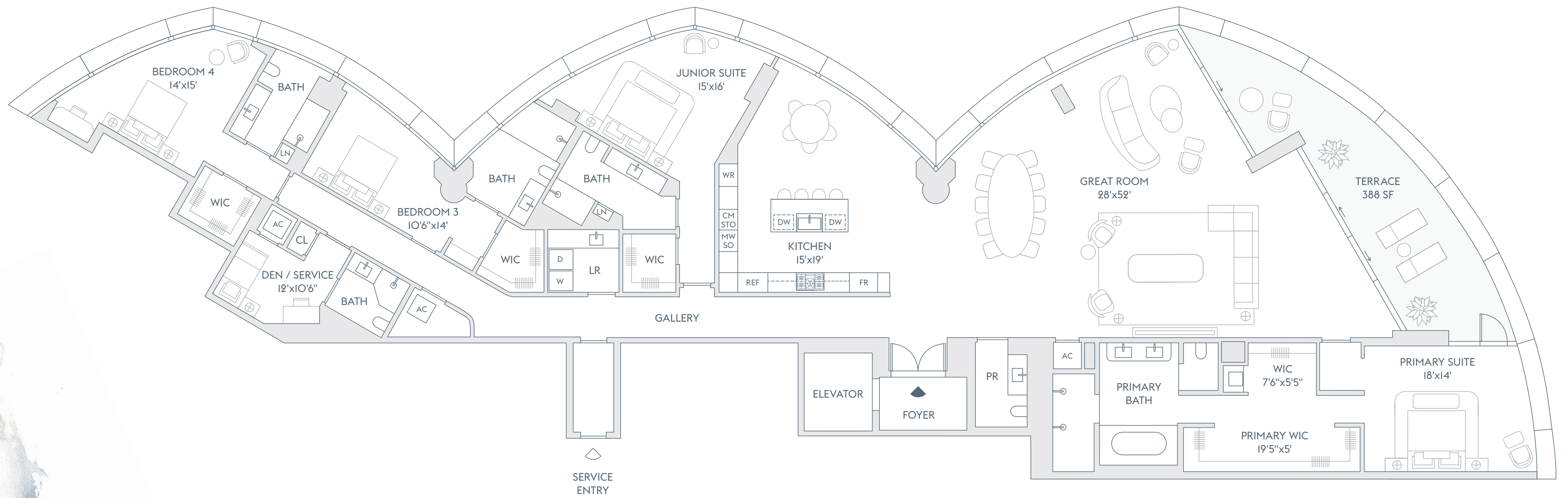

The dimensions stated for any depicted Unit floor plan are approximate because there are various recognized methods for calculating the square footage of a Unit. The square footage stated herein is calculated from the exterior boundaries of the exterior walls to the centerline of interior demising walls without deductions for cutouts, curves, or architectural features. This method typically results in quoted dimensions greater than the dimensions that would be determined by using other accepted methods. The floor plan, Unit layout, locations of windows, doors, closets, plumbing fixtures, mechanical equipment, appliances, structural elements, architectural design elements, and the uses, configurations, and entries to rooms may change based on final approved plans, permitting, and completed construction. The furniture layout and the uses of space illustrated are suggested uses only and not intended to guarantee any specific use of space or accommodation of specific furnishings. Consult the Developer's Prospectus to learn what is included with a Unit purchase and to review the Unit square footage calculation method to be relied upon. 2023© Carlton Terrace Owner LLC, with all rights reserved.

# RIVAGE

BAL HARBOUR

RESIDENCE  
**A**

FLOORS  
**18-21**

4 BEDROOMS  
6 BATHROOMS  
POWDER ROOM  
OFFICE / BEDROOM

FAMILY ROOM  
DEN  
SERVICE

INTERIOR  
6,655 SF | 618 SQM

EXTERIOR  
876 SF | 81 SQM

TOTAL  
7,531 SF | 700 SQM

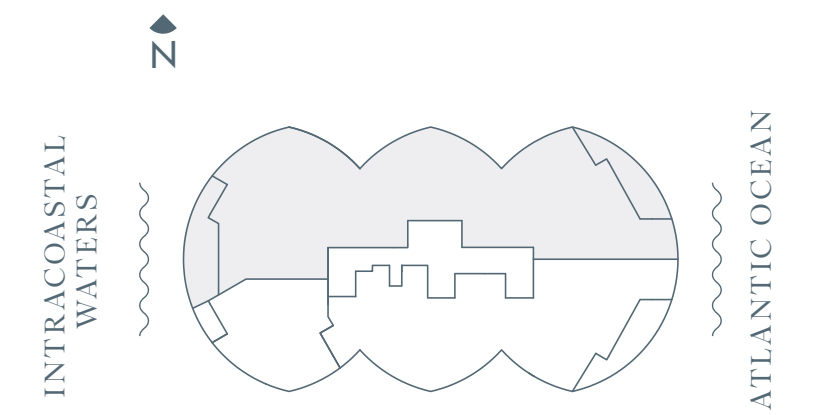
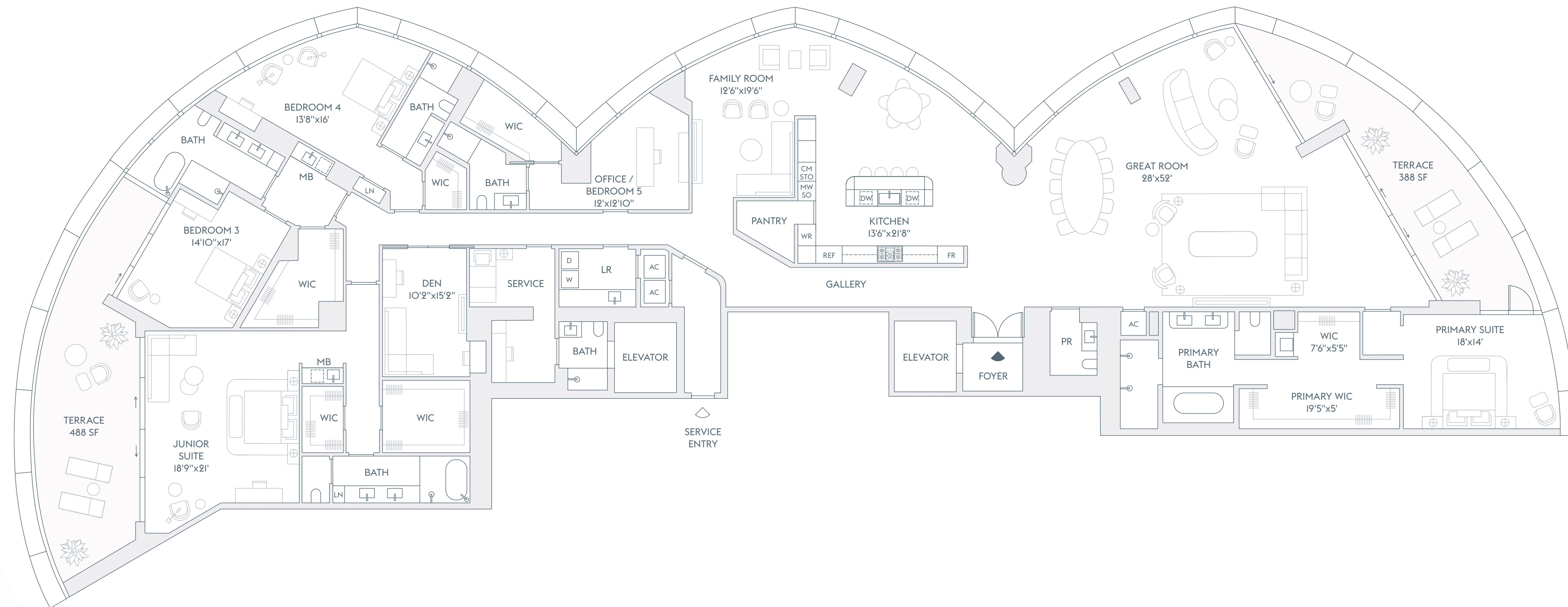

The dimensions stated for any depicted Unit floor plan are approximate because there are various recognized methods for calculating the square footage of a Unit. The square footage stated herein is calculated from the exterior boundaries of the exterior walls to the centerline of interior demising walls without deductions for cutouts, curves, or architectural features. This method typically results in quoted dimensions greater than the dimensions that would be determined by using other accepted methods. The floor plan, Unit layout, locations of windows, doors, closets, plumbing fixtures, mechanical equipment, appliances, structural elements, architectural design elements, and the uses, configurations, and entries to rooms may change based on final approved plans, permitting, and completed construction. The furniture layout and the uses of space illustrated are suggested uses only and not intended to guarantee any specific use of space or accommodation of specific furnishings. Consult the Developer's Prospectus to learn what is included with a Unit purchase and to review the Unit square footage calculation method to be relied upon. 3023D Carlton Terrace Owner LLC, with all rights reserved.

# RIVAGE

BAL HARBOUR

RESIDENCE  
**B**

FLOORS  
**3-17**

4 BEDROOMS  
5 BATHROOMS  
POWDER ROOM  
DEN / SERVICE

INTERIOR  
4,358 SF | 405 SQM

EXTERIOR  
388 SF | 36 SQM

TOTAL  
4,746 SF | 441 SQM

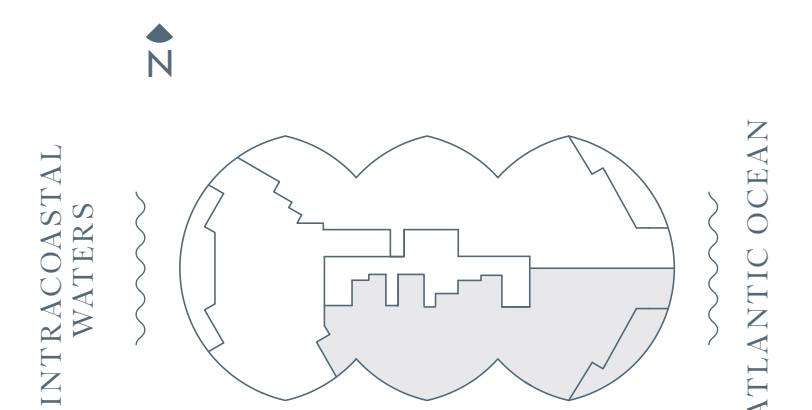
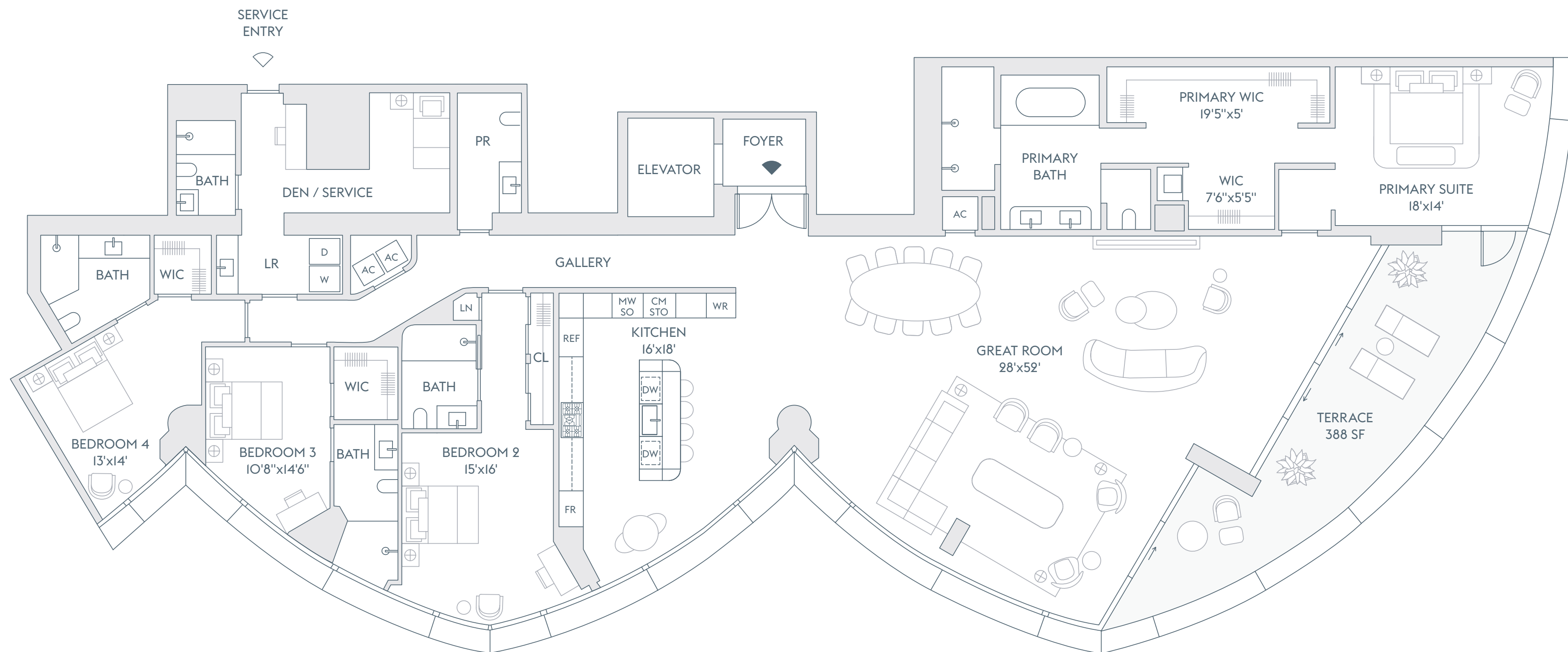

The dimensions stated for any depicted Unit floor plan are approximate because there are various recognized methods for calculating the square footage of a Unit. The square footage stated herein is calculated from the exterior boundaries of the exterior walls to the centerline of interior demising walls without deductions for cutouts, curves, or architectural features. This method typically results in quoted dimensions greater than the dimensions that would be determined by using other accepted methods. The floor plan, Unit layout, locations of windows, doors, closets, plumbing fixtures, mechanical equipment, appliances, structural elements, architectural design elements, and the uses, configurations, and entries to rooms may change based on final approved plans, permitting, and completed construction. The furniture layout and the uses of space illustrated are suggested uses only and not intended to guarantee any specific use of space or accommodation of specific furnishings. Consult the Developer's Prospectus to learn what is included with a Unit purchase and to review the Unit square footage calculation method to be relied upon. 2023© Carlton Terrace Owner LLC, with all rights reserved.



# RIVAGE

BAL HARBOUR

RESIDENCE  
**B**

FLOORS  
**18-21**

4 BEDROOMS  
6 BATHROOMS  
POWDER ROOM  
OFFICE / BEDROOM

FAMILY ROOM  
DEN  
SERVICE

INTERIOR  
5,810 SF | 540 SQM

EXTERIOR  
485 SF | 45 SQM

TOTAL  
6,295 SF | 585 SQM

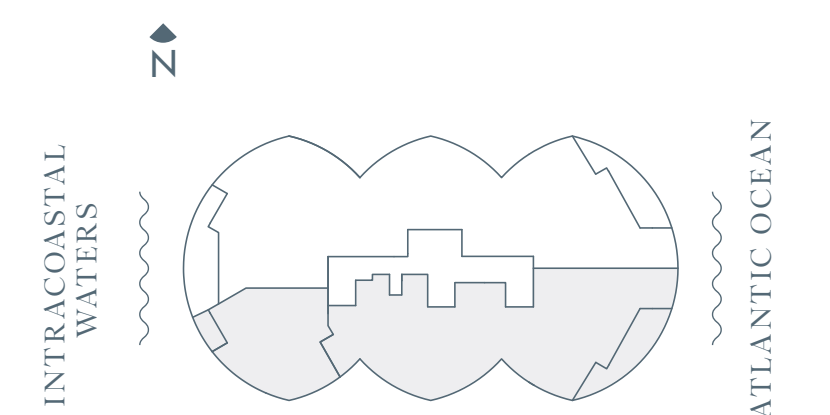
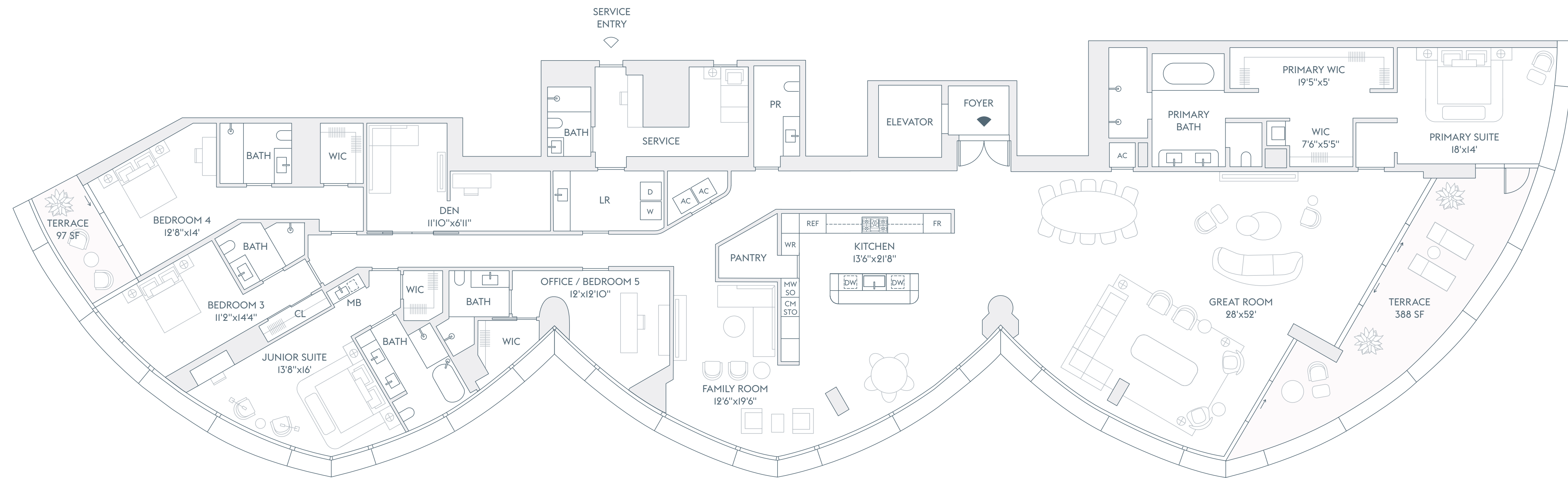

The dimensions stated for any depicted Unit floor plan are approximate because there are various recognized methods for calculating the square footage of a Unit. The square footage stated herein is calculated from the exterior boundaries of the exterior walls to the centerline of interior demising walls without deductions for cutouts, curves, or architectural features. This method typically results in quoted dimensions greater than the dimensions that would be determined by using other accepted methods. The floor plan, Unit layout, locations of windows, doors, closets, plumbing fixtures, mechanical equipment, appliances, structural elements, architectural design elements, and the uses, configurations, and entries to rooms may change based on final approved plans, permitting, and completed construction. The furniture layout and the uses of space illustrated are suggested uses only and not intended to guarantee any specific use of space or accommodation of specific furnishings. Consult the Developer's Prospectus to learn what is included with a Unit purchase and to review the Unit square footage calculation method to be relied upon. 3023D Carlton Terrace Owner LLC, with all rights reserved.

# RIVAGE

BAL HARBOUR

BAY PENTHOUSE FLOORS  
**C 22, 23, 24**

5 BEDROOMS  
 9 BATHROOMS  
 POWDER ROOM  
 2 DENS / SERVICE  
 FAMILY ROOM

FITNESS STUDIO  
 SKY ROOM  
 OUTDOOR KITCHEN  
 POOL  
 PRIVATE ELEVATOR

INTERIOR  
 8,677 SF | 806 SQM  
 EXTERIOR  
 4,928 SF | 458 SQM

TOTAL  
 13,605 SF | 1,264 SQM

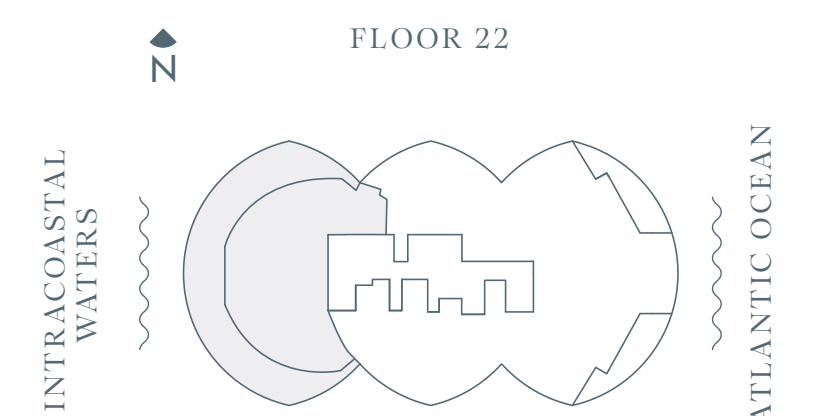
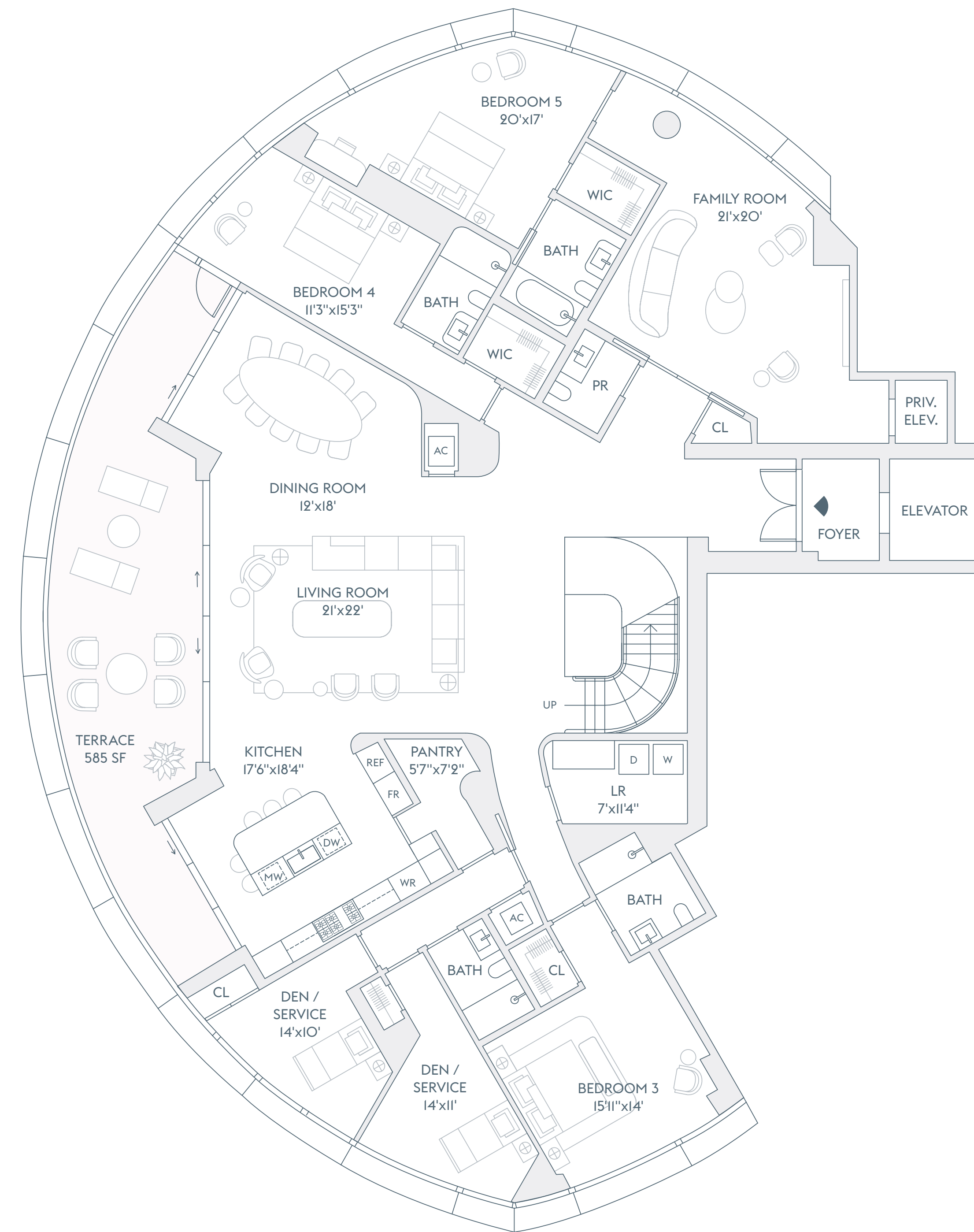
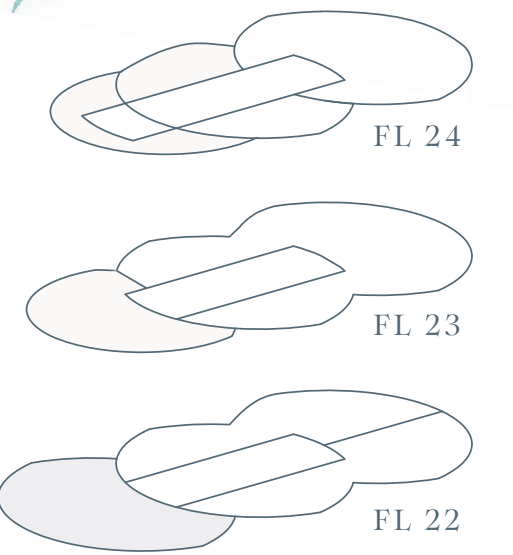

The dimensions stated for any depicted Unit floor plan are approximate because there are various recognized methods for calculating the square footage of a Unit. The square footage stated herein is calculated from the exterior boundaries of the exterior walls to the centerline of interior demising walls without deductions for cutouts, curves, or architectural features. This method typically results in quoted dimensions greater than the dimensions that would be determined by using other accepted methods. The floor plan, unit layout, locations of windows, doors, closets, plumbing fixtures, mechanical equipment, appliances, structural elements, architectural design elements, and the uses, configurations, and entries to rooms may change based on final approved plans, permitting, and completed construction. The furniture layout and the uses of space illustrated are suggested uses only and not intended to guarantee any specific use of space or accommodation of specific furnishings. Consult the Developer's Prospectus to learn what is included with a Unit purchase and to review the Unit square footage calculation method to be relied upon. 30230 Carlton Terrace Owner LLC, with all rights reserved.

# RIVAGE

BAL HARBOUR

BAY PENTHOUSE FLOORS  
**C 22, 23, 24**

5 BEDROOMS  
 9 BATHROOMS  
 POWDER ROOM  
 2 DENS / SERVICE  
 FAMILY ROOM

FITNESS STUDIO  
 SKY ROOM  
 OUTDOOR KITCHEN  
 POOL  
 PRIVATE ELEVATOR

INTERIOR  
 8,677 SF | 806 SQM  
 EXTERIOR  
 4,928 SF | 458 SQM

TOTAL  
 13,605 SF | 1,264 SQM

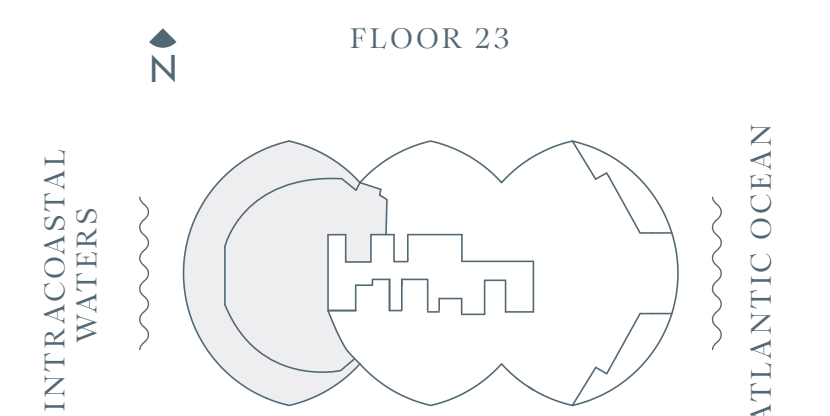
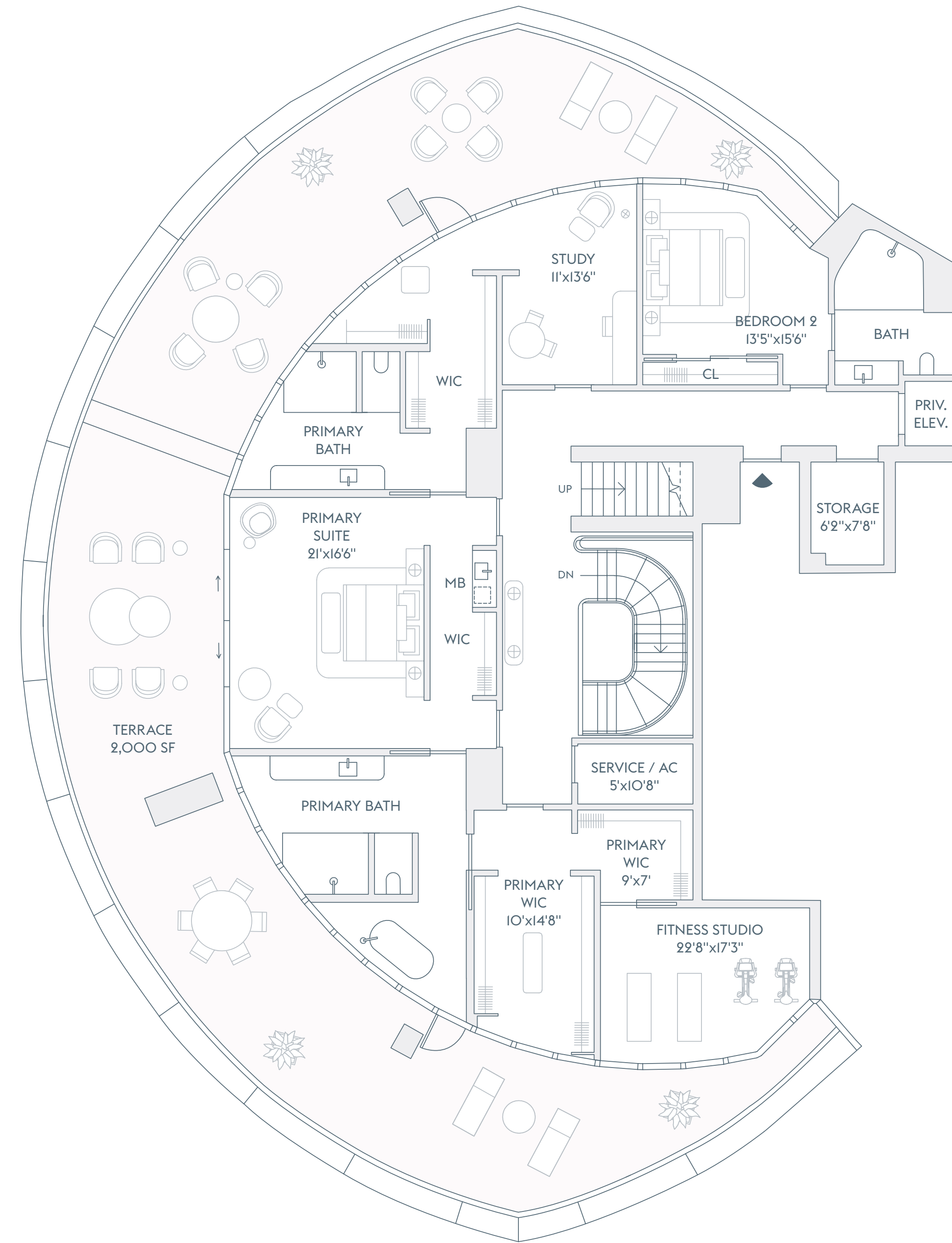
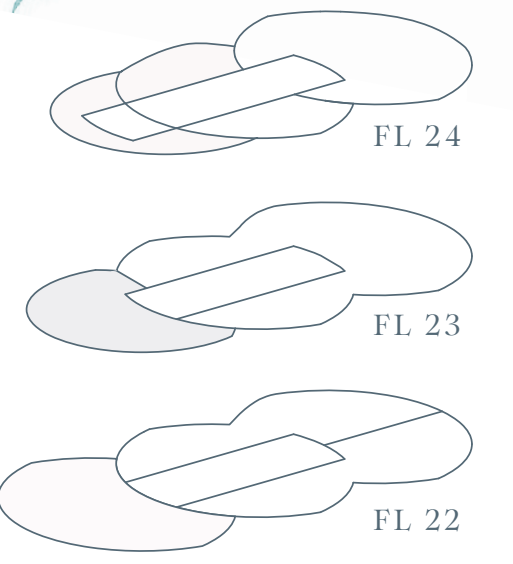

The dimensions stated for any depicted Unit floor plan are approximate because there are various recognized methods for calculating the square footage of a Unit. The square footage stated herein is calculated from the exterior boundaries of the exterior walls to the centerline of interior demising walls without deductions for cutouts, curves, or architectural features. This method typically results in quoted dimensions greater than the dimensions that would be determined by using other accepted methods. The floor plan, unit layout, locations of windows, doors, closets, plumbing fixtures, mechanical equipment, appliances, structural elements, architectural design elements, and the uses, configurations, and entries to rooms may change based on final approved plans, permitting, and completed construction. The furniture layout and the uses of space illustrated are suggested uses only and not intended to guarantee any specific use of space or accommodation of specific furnishings. Consult the Developer's Prospectus to learn what is included with a Unit purchase and to review the Unit square footage calculation method to be relied upon. 3023D Carlton Terrace Owner LLC, with all rights reserved.

# RIVAGE

BAL HARBOUR

BAY PENTHOUSE FLOORS  
**C 22, 23, 24**

5 BEDROOMS	FITNESS STUDIO	INTERIOR
9 BATHROOMS	SKY ROOM	8,677 SF   806 SQM
POWDER ROOM	OUTDOOR KITCHEN	
2 DENS / SERVICE	POOL	EXTERIOR
FAMILY ROOM	PRIVATE ELEVATOR	4,928 SF   458 SQM

TOTAL  
 13,605 SF | 1,264 SQM

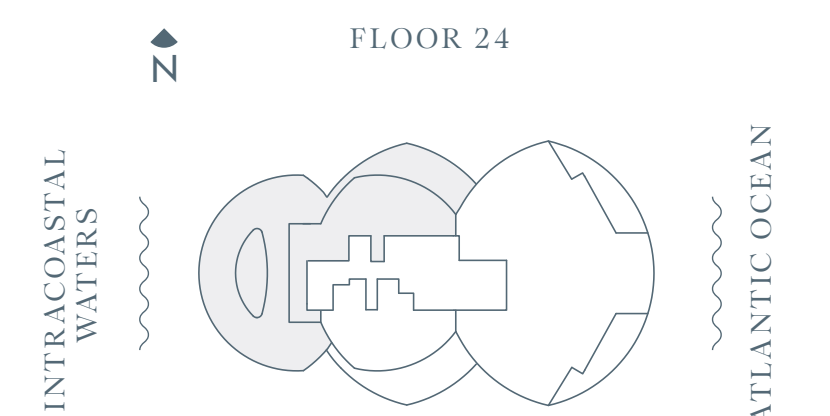
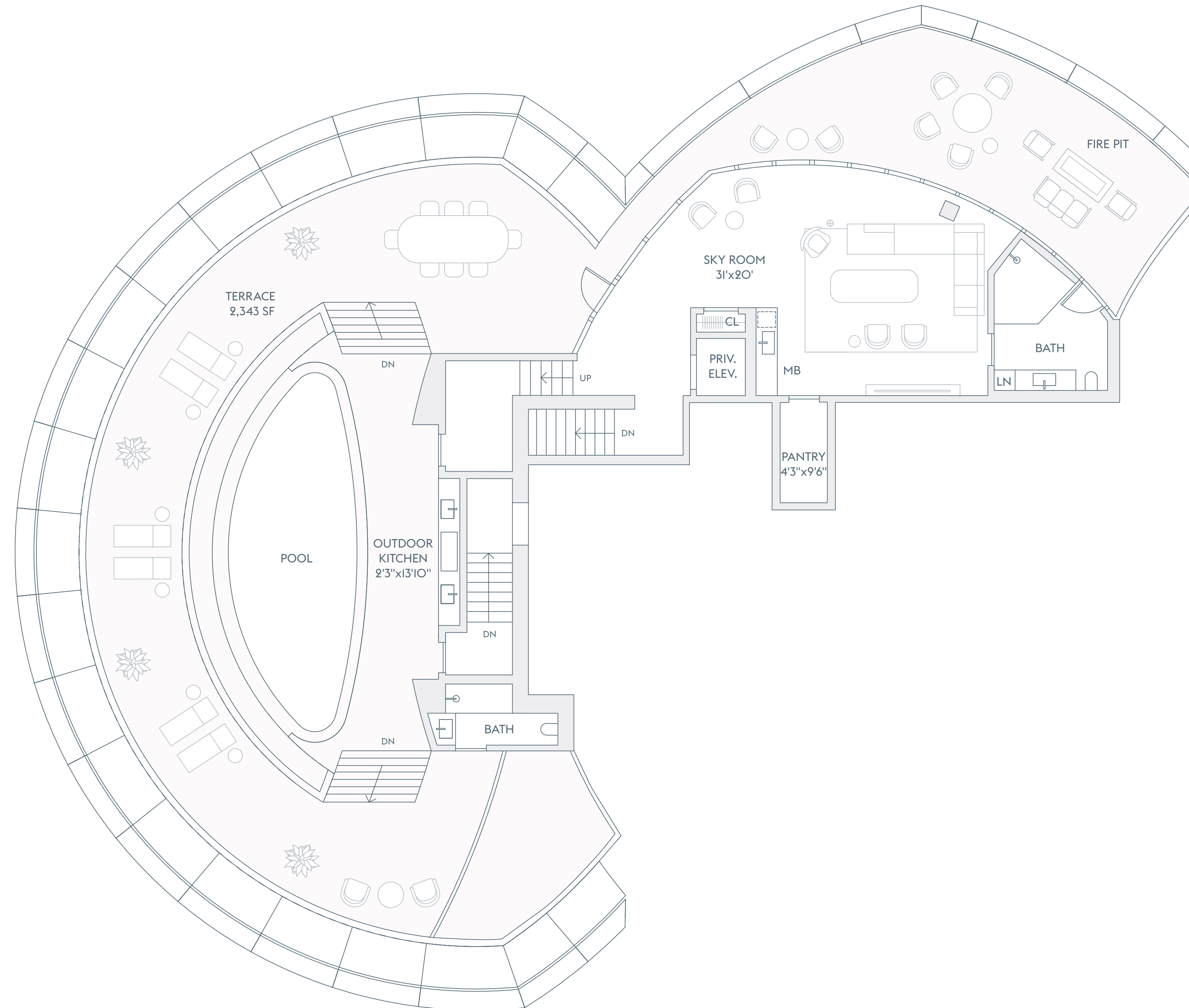
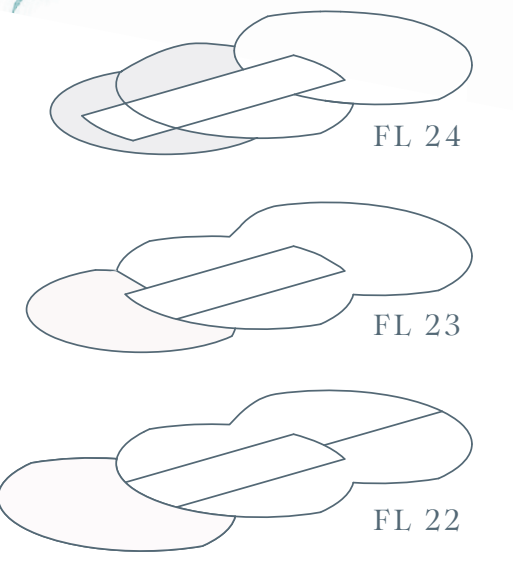

The dimensions stated for any depicted Unit floor plan are approximate because there are various recognized methods for calculating the square footage of a Unit. The square footage stated herein is calculated from the exterior boundaries of the exterior walls to the centerline of interior demising walls without deductions for cutouts, curves, or architectural features. This method typically results in quoted dimensions greater than the dimensions that would be determined by using other accepted methods. The floor plan, Unit layout, locations of windows, doors, closets, plumbing fixtures, mechanical equipment, appliances, structural elements, architectural design elements, and the uses, configurations, and entries to rooms may change based on final approved plans, permitting, and completed construction. The furniture layout and the uses of space illustrated are suggested uses only and not intended to guarantee any specific use of space or accommodation of specific furnishings. Consult the Developer's Prospectus to learn what is included with a Unit purchase and to review the Unit square footage calculation method to be relied upon. ©2020 Carlton Terrace Owner LLC, with all rights reserved.

# RIVAGE

BAL HARBOUR

RESIDENCE

# C

FLOORS

# 3-17

3 BEDROOMS  
3 BATHROOMS  
POWDER ROOM

INTERIOR  
3,297 SF | 306 SQM

EXTERIOR  
585 SF | 54 SQM

TOTAL  
3,882 SF | 361 SQM

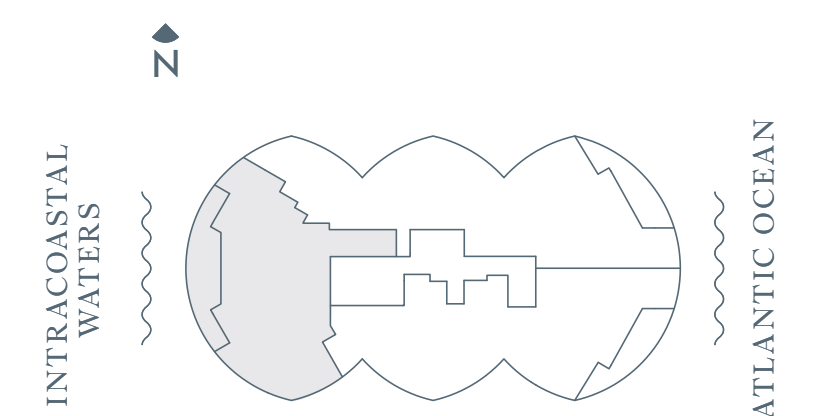
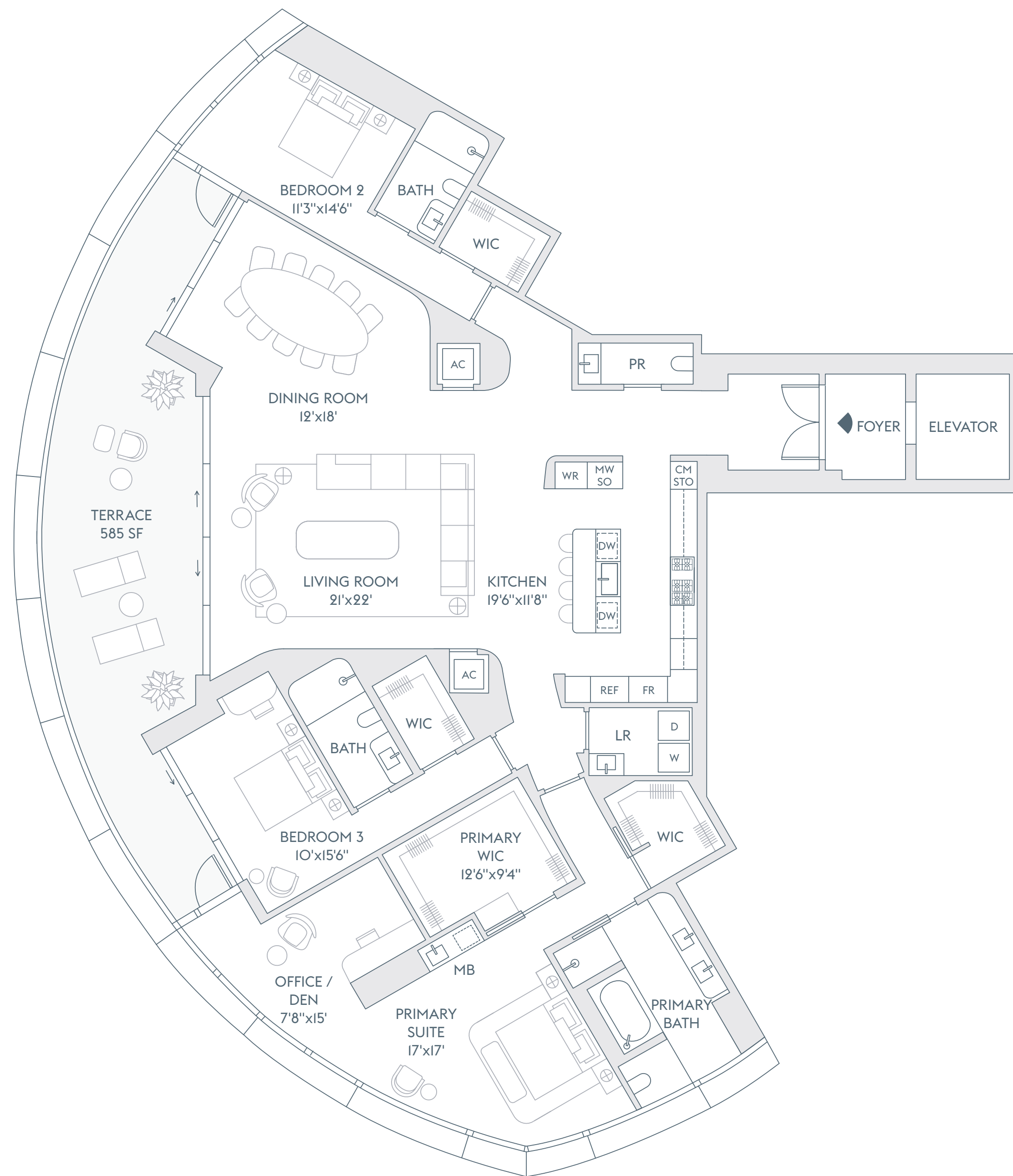

The dimensions stated for any depicted Unit floor plan are approximate because there are various recognized methods for calculating the square footage of a Unit. The square footage stated herein is calculated from the exterior boundaries of the exterior walls to the centerline of interior demising walls without deductions for cutouts, curves, or architectural features. This method typically results in quoted dimensions greater than the dimensions that would be determined by using other accepted methods. The floor plan, Unit layout, locations of windows, doors, closets, plumbing fixtures, mechanical equipment, appliances, structural elements, architectural design elements, and the uses, configurations, and entries to rooms may change based on final approved plans, permitting, and completed construction. The furniture layout and the uses of space illustrated are suggested uses only and not intended to guarantee any specific use of space or accommodation of specific furnishings. Consult the Developer's Prospectus to learn what is included with a Unit purchase and to review the Unit square footage calculation method to be relied upon. 2023© Carlton Terrace Owner LLC, with all rights reserved.