

# A104

Indoor: 3,530 SF  
Outdoor: 1,080 SF  
Total: 4,600 SF  
290 SF Covered Terrace



3 BED + STUDY / 4 BATH



# B302

3 bed+study  
4 bath

Indoor: 3,400 SF  
Outdoor: 500 SF  
Total: 3,900 SF

300 SF Covered Terrace  
200 SF Uncovered Terrace

# C A R E T T A



↑ Privacy Screen  
42" Wall With Opaque  
Glass To 6' 0"

Stated dimensions are measured following BOMA standards to the exterior boundaries of the exterior walls and the centerline of interior demising walls (without deductions for interior columns, shear walls or shafts) and in fact vary from the dimensions that would be determined by using the description and definition of the "Unit" set forth in the Declaration (which generally only includes the interior airspace between the perimeter walls and excludes interior structural components, shear walls and shafts). For the calculation of the unit area following the definition of the unit set forth in the Declaration, see Exhibit "3-1" of the Declaration. Additionally, measurements of rooms set forth on any floor plan are generally taken at the greatest points of each given room (as if the room were a perfect rectangle), without regard for any cutouts. Accordingly, the area of the actual room will typically be smaller than the product obtained by multiplying the stated length times width. All dimensions are approximate, and all floor plans and development plans are subject to change.



LiveCaretta.com

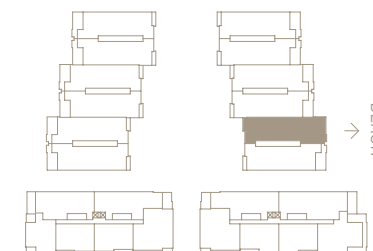

**jdl.**

# B501

# C A R E T T A

4 bed  
 5.1 bath  
 Indoor: 5,590 SF  
 Outdoor: 2,210 SF  
 Total: 7,800 SF  
 2,210 SF Uncovered Terrace



Stated dimensions are measured following BOMA standards to the exterior boundaries of the exterior walls and the centerline of interior demising walls (without deductions for interior columns, shear walls or shafts) and in fact vary from the dimensions that would be determined by using the description and definition of the "Unit" set forth in the Declaration (which generally only includes the interior airspace between the perimeter walls and excludes interior structural components, shear walls and shafts). For the calculation of the unit area following the definition of the unit set forth in the Declaration, see Exhibit "3-1" of the Declaration. Additionally, measurements of rooms set forth on any floor plan are generally taken at the greatest points of each given room (as if the room were a perfect rectangle), without regard for any cutouts. Accordingly, the area of the actual room will typically be smaller than the product obtained by multiplying the stated length times width. All dimensions are approximate, and all floor plans and development plans are subject to change.



LiveCaretta.com

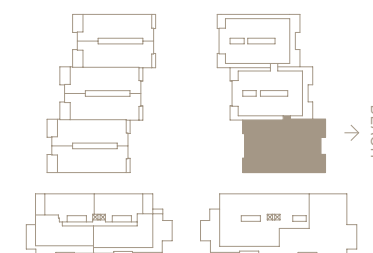

jdl.