



WHERE EXCLUSIVITY IS
THE ULTIMATE LUXURY



RESIDENCE LEVELS 2 - 4

~ BISCAYNE BAY ~

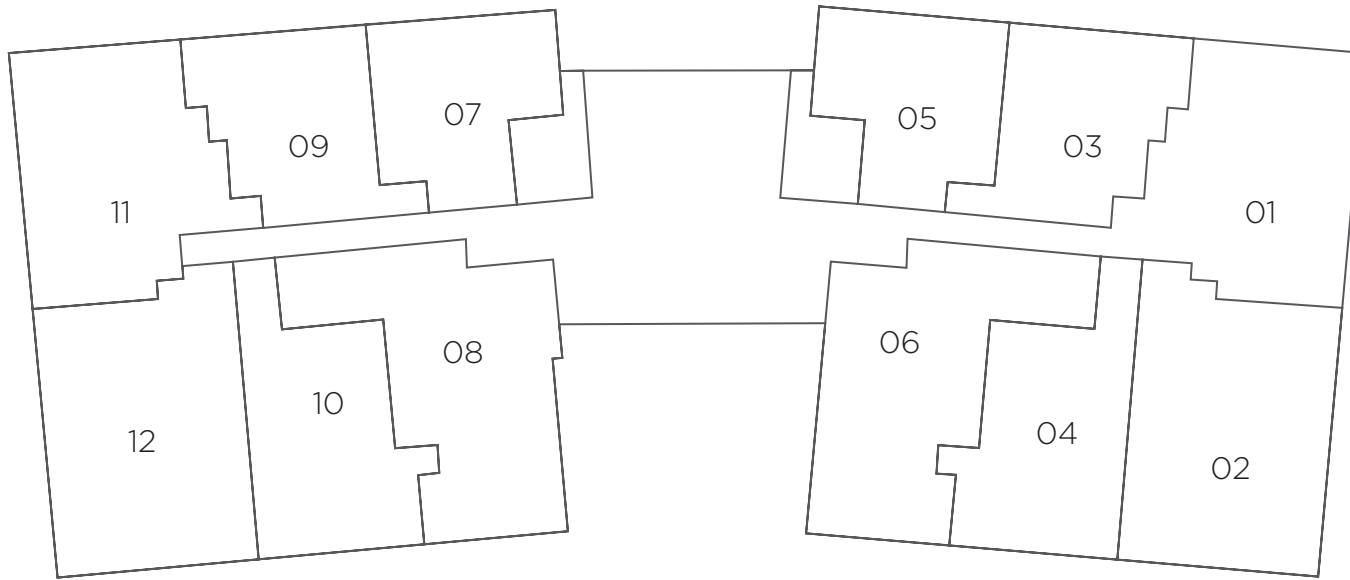

~ PARK ~

BAY VIEWS

Residences 01 & 11

3 Bedrooms, 3.5 Bathrooms
1,748 square feet

Residences 03 & 09

2 Bedrooms, 2.5 Bathrooms
1,327 square feet

Residences 05 & 07

2 Bedrooms, 2.5 Bathrooms
1,329 square feet

PARK VIEWS

Residences 02 & 12

2 Bedrooms, 2.5 Bathrooms
1,420 square feet

Residences 04 & 10

1 Bedroom, 1.5 Bathrooms
1,125 square feet

Duplex Residences 04 & 10

Levels 3 & 4

3 Bedrooms, 3 Bathrooms, + Den
2,184 square feet

Residences 06 & 08

2 Bedrooms, 2.5 Bathrooms, + Den
1,391 square feet

RESIDENCE LEVELS 5 - 6

~ BISCAYNE BAY ~

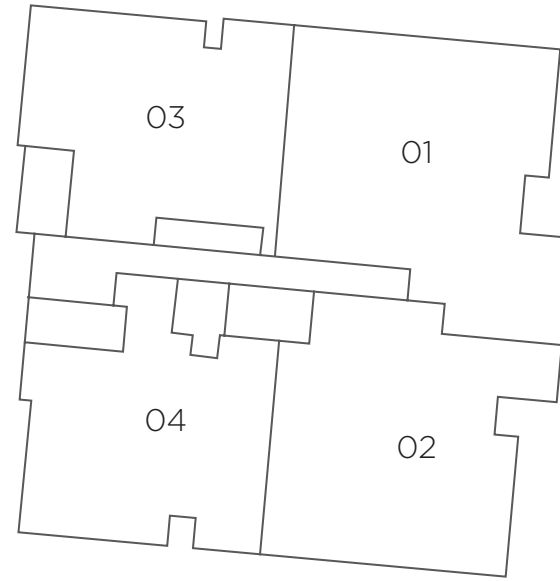
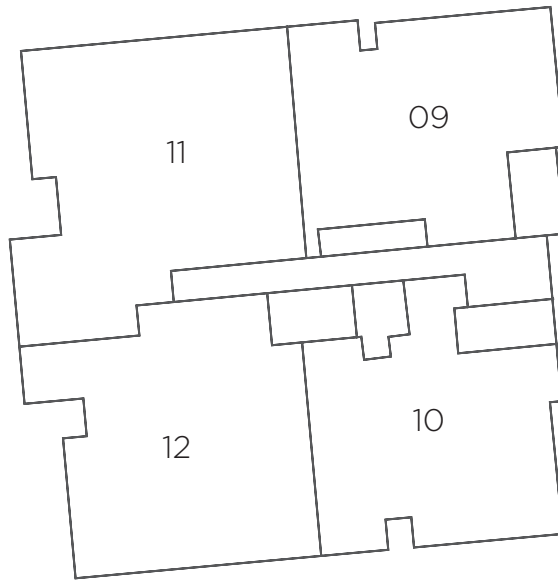

~ PARK ~

BAY VIEWS

Residences 01 & 11

4 Bedrooms, 4.5 Bathrooms
2,497 square feet

Residences 03 & 09

3 Bedrooms, 3.5 Bathrooms
1,830 square feet

PARK VIEWS

Residences 02 & 12

3 Bedrooms, 3 Bathrooms, + Den
2,068 square feet

Residences 04 & 10

2 Bedrooms, 2.5 Bathrooms, + Den
1,861 square feet

UPPER AND LOWER PENTHOUSE LEVELS 7 - 8

~ BISCAYNE BAY ~

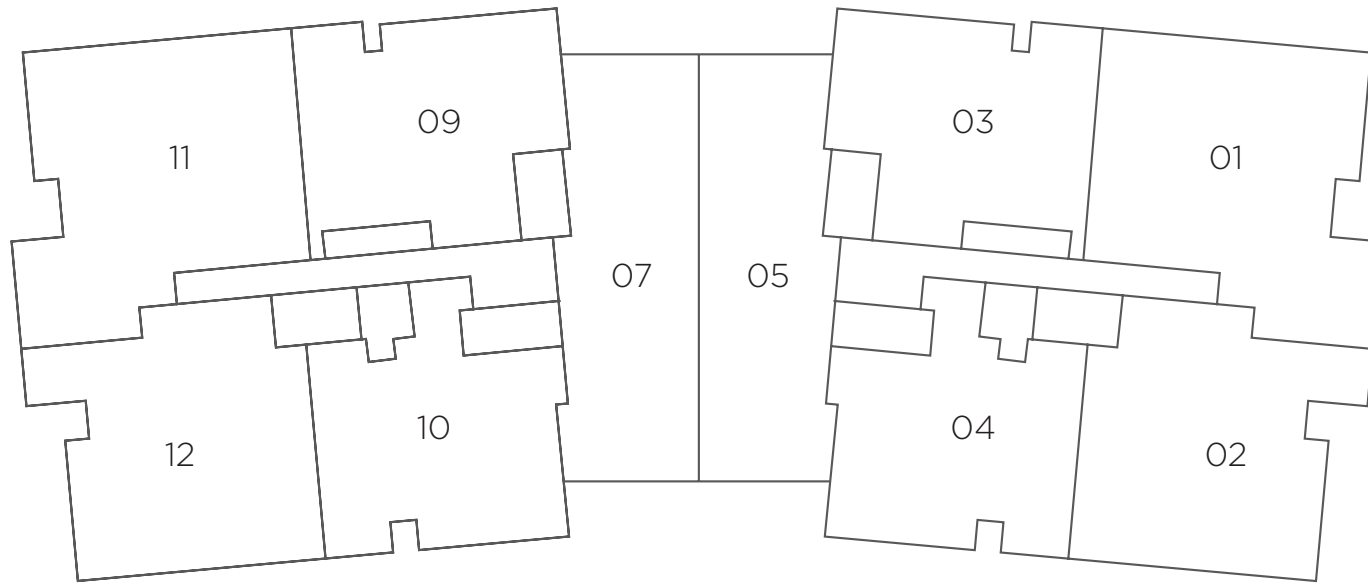

~ PARK ~

BAY VIEWS

Residence 01 & 11

4 Bedrooms, 4.5 Bathrooms
2,348 square feet (Level 8)
2,497 square feet (Level 7)

Flow-Through Residences 05 & 07

3 Bedrooms, 3.5 Bathrooms
1,858 square feet

Residences 03 & 09

3 Bedrooms, 3.5 Bathrooms
1,830 square feet

PARK VIEWS

Residences 02 & 12

3 Bedrooms, 3 Bathrooms, + Den
2,068 square feet

Residences 04 & 10

2 Bedrooms, 2.5 Bathrooms
1,851 square feet



LA BAIA, BAY HARBOR ISLANDS

Site Address

9201 East Bay Harbor Drive, Bay Harbor Islands, Florida 33154

Exclusive Sales by PGutman, LLC

Developed by the Continuum Company

labaiabayharbor.com



PGUTMAN LLC



CONTINUUM
COMPANY

ORAL REPRESENTATIONS CANNOT BE RELIED UPON AS CORRECTLY STATING THE REPRESENTATIONS OF THE DEVELOPER. FOR CORRECT REPRESENTATIONS, MAKE REFERENCE TO THIS BROCHURE AND TO THE DOCUMENTS REQUIRED BY SECTION 718.503, FLORIDA STATUTES, TO BE FURNISHED BY A DEVELOPER TO A BUYER OR LESSEE.

Ian Bruce Eichner ("IBE") is not the project Developer. This Condominium is being developed by Bay Harbor Islands Property Owner I LLC, a Delaware limited liability company ("Developer"). Any and all statements, disclosures and/or representations shall be deemed made by Developer and not by IBE and any purchaser agrees to look solely to Developer (and not to IBE and/or any of his affiliates) with respect to any and all matters relating to the marketing and/or development of the Condominium and with respect to the sales of units in the Condominium. This is not intended to be an offer to sell, or solicitation to buy, condominium units to residents of any jurisdiction where prohibited by law, and your eligibility for purchase will depend upon your state of residency. This offering is made only by the prospectus for the condominium and no statement should be relied upon if not made in the prospectus. All features, specifications, brands, matters of detail are conceptual only and should not be relied upon as representations, express or implied, of the final detail of the residences or condominium. The Developer expressly reserves the right to make modifications, revisions, omissions and changes without notice. Certain features may not be included with all units. Square footages, ceiling heights are all subject to change. Developer makes no representations regarding views from any particular unit. Your purchase agreement will detail items included with the Unit.

