

THE
SHORECLUB



No.4

FOURTH FLOOR
RESIDENCE A

Four Bedrooms
Five Bathrooms
Powder Room

INTERIOR
4,456 square feet
414 square meters

EXTERIOR
623 square feet
55 square meters

TOTAL
5,097 square feet
469 square meters

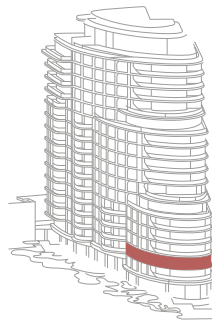
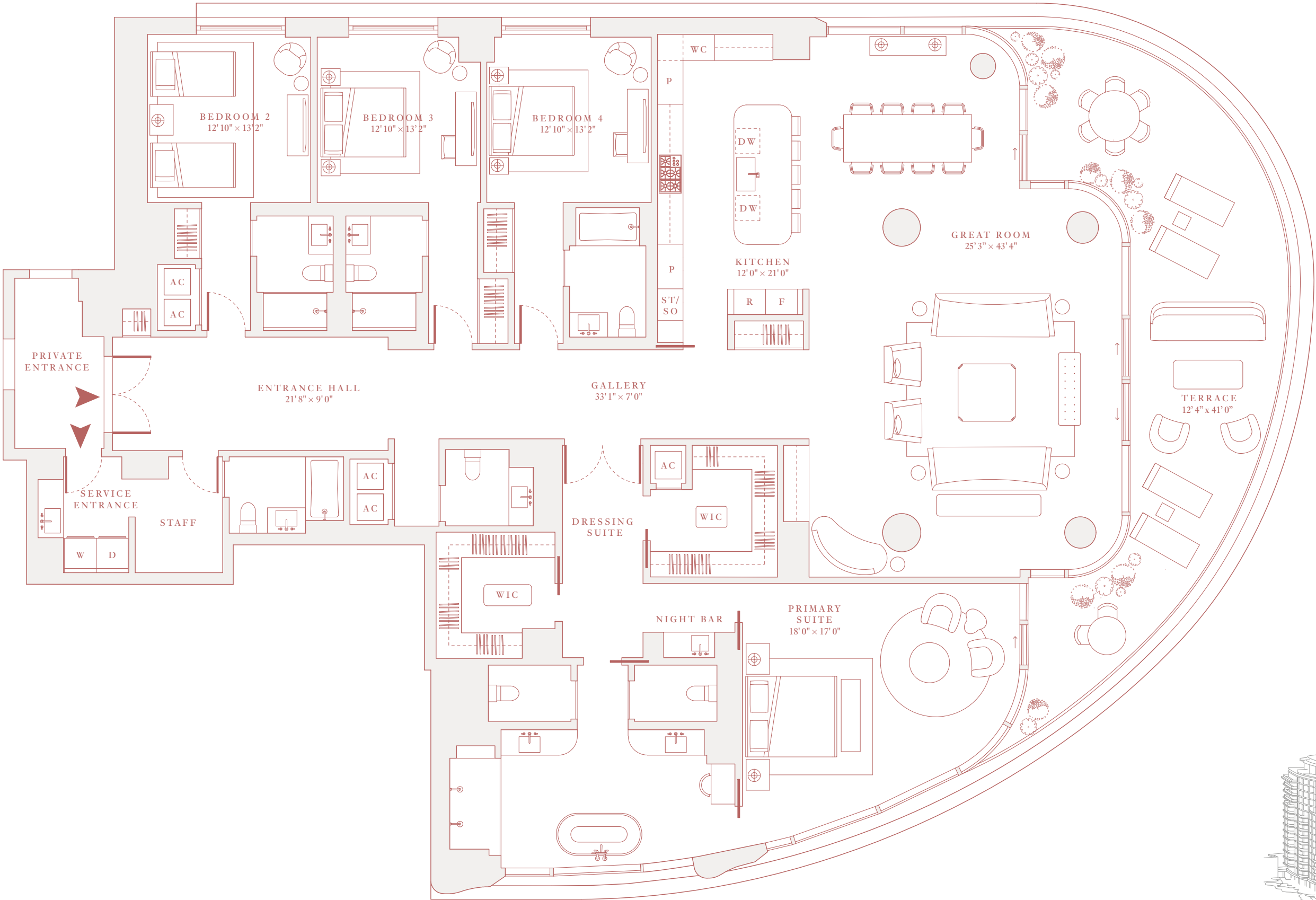

OCEAN

Developed by WITKOFF
Designed by ROBERT A. M. STERN

1901 COLLINS AVE, MIAMI BEACH, FL 33139
Website SCPRIVATECOLLECTION.COM

THE
SHORECLUB



No.11

11A

ELEVENTH FLOOR RESIDENCE A

Five Bedrooms
Five Bathrooms
Powder Room

INTERIOR

4,693 square feet
445 square meters

EXTERIOR

649 square feet
60 square meters

TOTAL

5,342 square feet
496 square meters



Developed by WITKOFF
Designed by ROBERT A. M. STERN ARCHITECTS

1901 COLLINS AVE, MIAMI BEACH, FL 33139
Website SCPRIVATECOLLECTION.COM

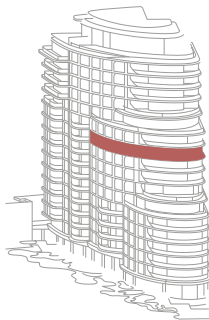

OCEAN

4B

FOURTH FLOOR RESIDENCE B

Three Bedrooms
Three Bathrooms
Powder Room

INTERIOR

3,123 square feet
290 square meters

EXTERIOR

522 square feet
48 square meters

TOTAL

3,645 square feet
642 square meters

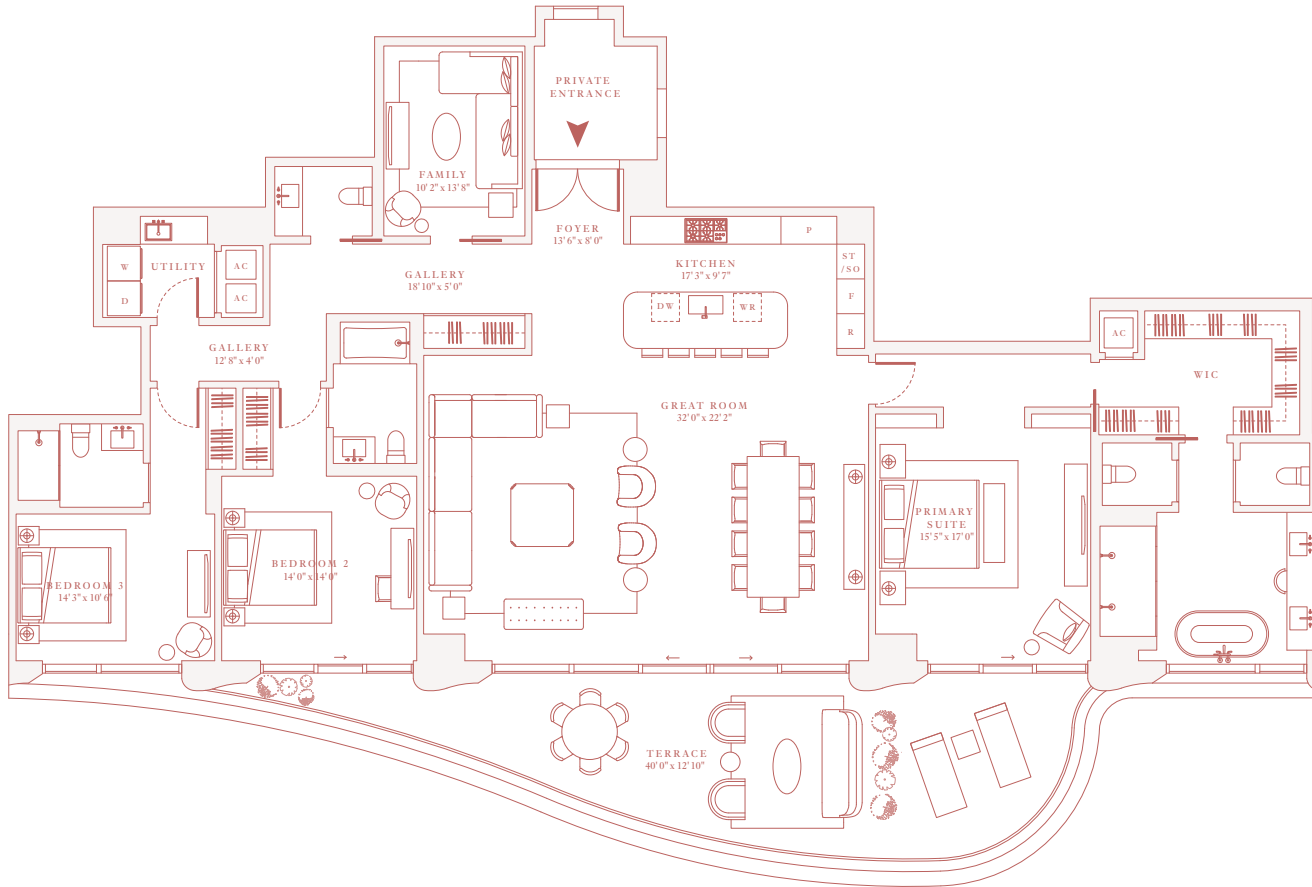

Developed by WITKOFF

Designed by ROBERT A. M. STERN

1901 COLLINS AVE, MIAMI BEACH, FL 33139

Website SCPRIVATECOLLECTION.COM

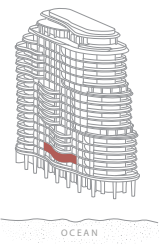

Witkoff

Douglas Elliman
Development Marketing



Stated square footages and dimensions are measured to the exterior boundaries of the exterior walls and the centerline of interior dividing walls and in fact vary from the square footages and dimensions that would be determined by using the description and definition of the "Unit" set forth in the Declaration (which generally only includes the interior airspace between the perimeter walls and excludes all interior structural components and other common elements). This method is generally used in sales materials and is provided to allow a prospective buyer to compare the Units with units in other condominium projects that utilize the same method. For your reference, the area of the Unit, determined in accordance with these defined unit boundaries is described on Exhibit 3 to the Declaration. Measurements of rooms set forth on this floor plan are generally taken at the furthest points of each given room (as if the room were a perfect rectangle), without regard for any setbacks or variations. Accordingly, the area of the actual rooms will typically be smaller than the product obtained by multiplying the stated length and width. All dimensions are estimates which will vary with actual construction, and all floor plans, specifications and other development plans are subject to change and will not necessarily accurately reflect the final plans and specifications for the development.

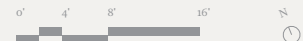

7B

SEVENTH FLOOR RESIDENCE B

Three Bedrooms
Three Bathrooms
Powder Room

INTERIOR

3,123 square feet
290 square meters

EXTERIOR

522 square feet
48 square meters

TOTAL

3,645 square feet
642 square meters

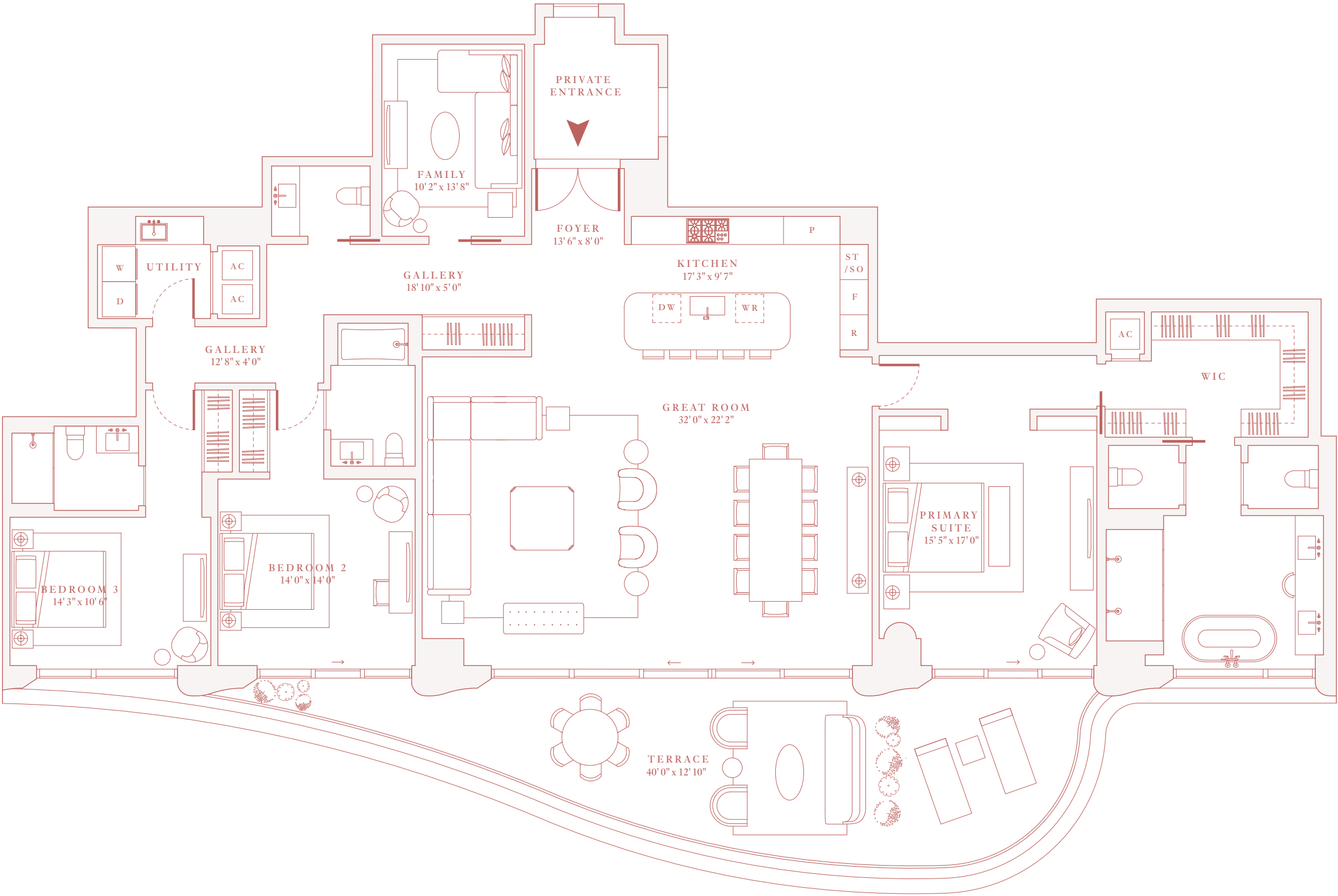

Developed by WITKOFF
Designed by ROBERT A. M. STERN

1901 COLLINS AVE, MIAMI BEACH, FL 33139
Website SCPRIVATECOLLECTION.COM

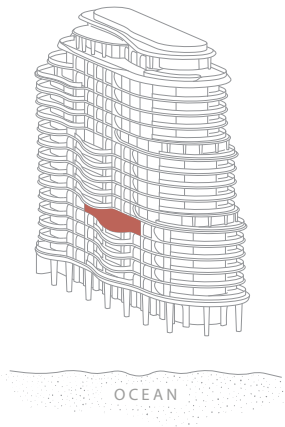

5C

FIFTH FLOOR RESIDENCE C

Two Bedrooms
Two Bathrooms
Powder Room

INTERIOR
2,482 square feet
230 square meters

EXTERIOR
417 square feet
39 square meters

TOTAL
2,899 square feet
269 square meters

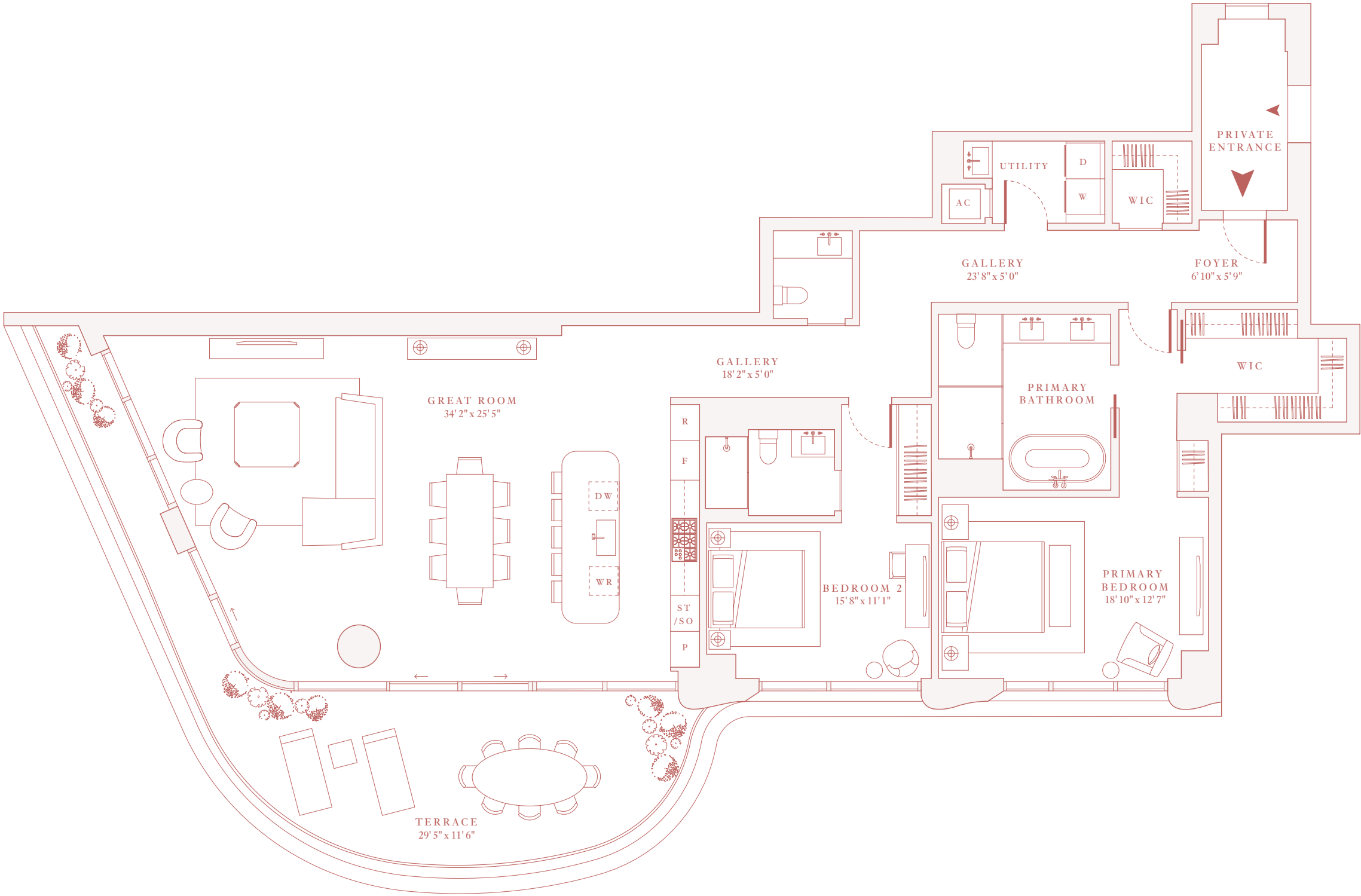

Developed by WITKOFF
Designed by ROBERT A. M. STERN

1901 COLLINS AVE, MIAMI BEACH, FL 33139
Website SCPRIVATECOLLECTION.COM

