

01

FLOOR 6 – 26

SOUTH TOWER

3 BEDROOMS

3 BATHROOMS

POWDER ROOM

2,635 SQ. FT. INTERIOR

355 SQ. FT. EXTERIOR

CORNER RESIDENCE 10' CEILINGS

CUSTOM DESIGED ITALKRAFT KITCHEN

WITH 14 FT. ISLAND AND DOUBLE-SINKS

PRIMARY BATHROOM INCLUDES

SPRAWLING GLASS SHOWERS WITH

SOAKING TUB, NICHE WITH LIGHTING

SERVICE ENTRANCE

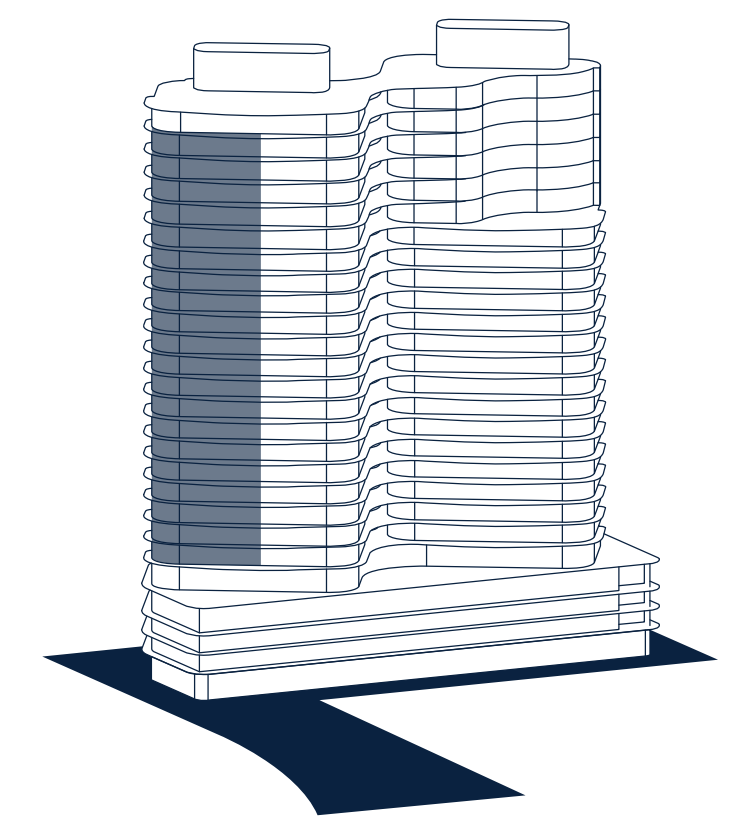

2785 NE 183RD STREET, AVENTURA FL 33160

Stated dimensions are measured to the exterior boundaries of the exterior walls and the centerline of interior demising walls and in fact vary from the dimensions that would be determined by using the description and definition of the "Unit" set forth in the Declaration (which generally only includes the interior airspace between the perimeter walls and excludes interior structural components). Note that measurements of rooms set forth on this floor plan are generally taken at the greatest points of each given room (as if the room were a perfect rectangle), without regard for any cutouts. Accordingly, the area of the actual room will typically).



02
FLOOR 6—26
SOUTH TOWER

5 BEDROOMS
5 BATHROOMS

3,545 SQ. FT. INTERIOR
655 SQ. FT. EXTERIOR

CORNER RESIDENCE 10' CEILINGS
CUSTOM DESIGNED ITALKRAFT KITCHEN
WITH 14 FT. ISLAND AND DOUBLE-SINKS
PRIMARY BATHROOM INCLUDES
SPRAWLING GLASS SHOWERS WITH
SOAKING TUB, NICHE WITH LIGHTING
SERVICE ENTRANCE

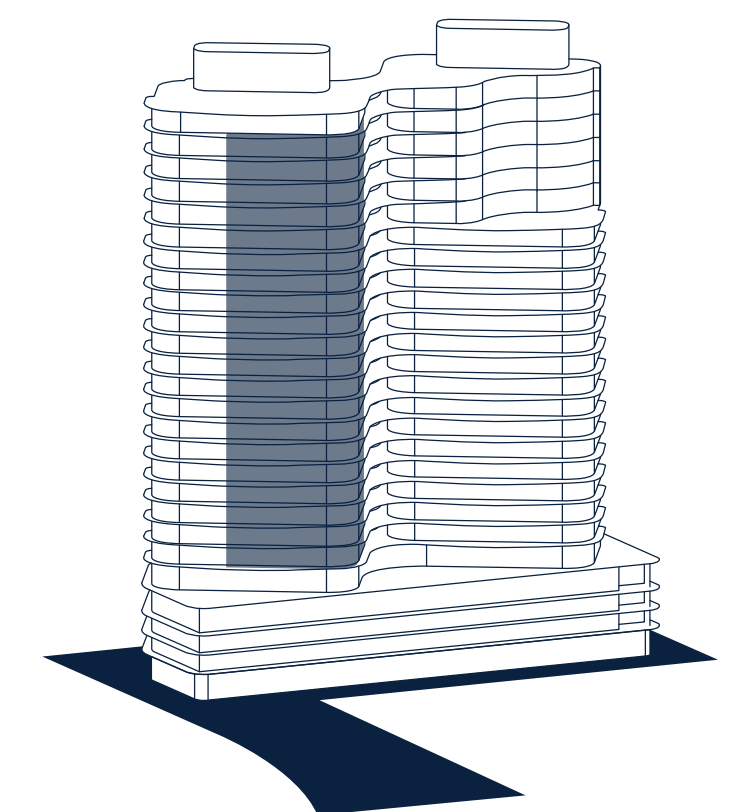

2785 NE 183RD STREET, AVENTURA FL 33160

Stated dimensions are measured to the exterior boundaries of the exterior walls and the centerline of interior demising walls and in fact vary from the dimensions that would be determined by using the description and definition of the "Unit" set forth in the Declaration (which generally only includes the interior airspace between the perimeter walls and excludes interior structural components). Note that measurements of rooms set forth on this floor plan are generally taken at the greatest points of each given room (as if the room were a perfect rectangle), without regard for any cutouts. Accordingly, the area of the actual room will typically).



03

FLOOR 6—14

NORTH TOWER

3 BEDROOMS

3 BATHROOMS

POWDER ROOM

SKY TERRACE

2,240 SQ. FT. INTERIOR

620 SQ. FT. EXTERIOR

CORNER RESIDENCE 10' CEILINGS

CUSTOM DESIGNED ITALKRAFT KITCHEN

WITH DUAL BASIN PARTITIONED SINK

PRIMARY BATHROOM INCLUDES

SPRAWLING GLASS SHOWERS WITH

SOAKING TUB, NICHE WITH LIGHTING

SERVICE ENTRANCE

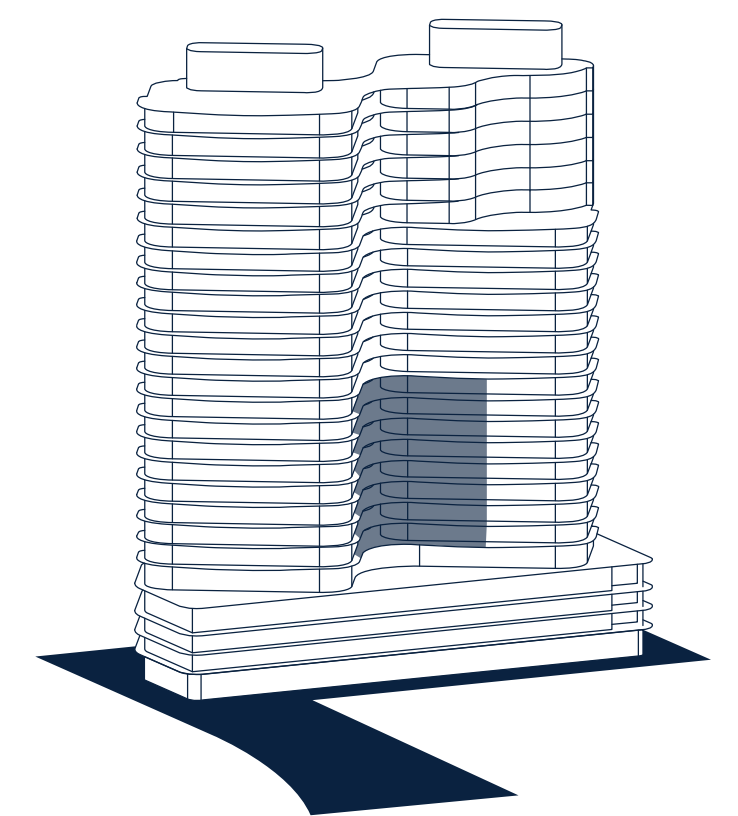

2785 NE 183RD STREET, AVENTURA FL 33160

Stated dimensions are measured to the exterior boundaries of the exterior walls and the centerline of interior demising walls and in fact vary from the dimensions that would be determined by using the description and definition of the "Unit" set forth in the Declaration (which generally only includes the interior airspace between the perimeter walls and excludes interior structural components). Note that measurements of rooms set forth on this floor plan are generally taken at the greatest points of each given room (as if the room were a perfect rectangle), without regard for any cutouts. Accordingly, the area of the actual room will typically).



03
FLOOR 15 – 21
NORTH TOWER

4 BEDROOMS
4 BATHROOMS
POWDER ROOM
SKY TERRACE

2,890 SQ. FT. INTERIOR
820 SQ. FT. EXTERIOR

CORNER RESIDENCE 10' CEILINGS
CUSTOM DESIGNED ITALKRAFT KITCHEN
WITH 14 FT. ISLAND AND DOUBLE-SINKS
PRIMARY BATHROOM INCLUDES
SPRAWLING GLASS SHOWERS WITH
SOAKING TUB, NICHE WITH LIGHTING
SERVICE ENTRANCE

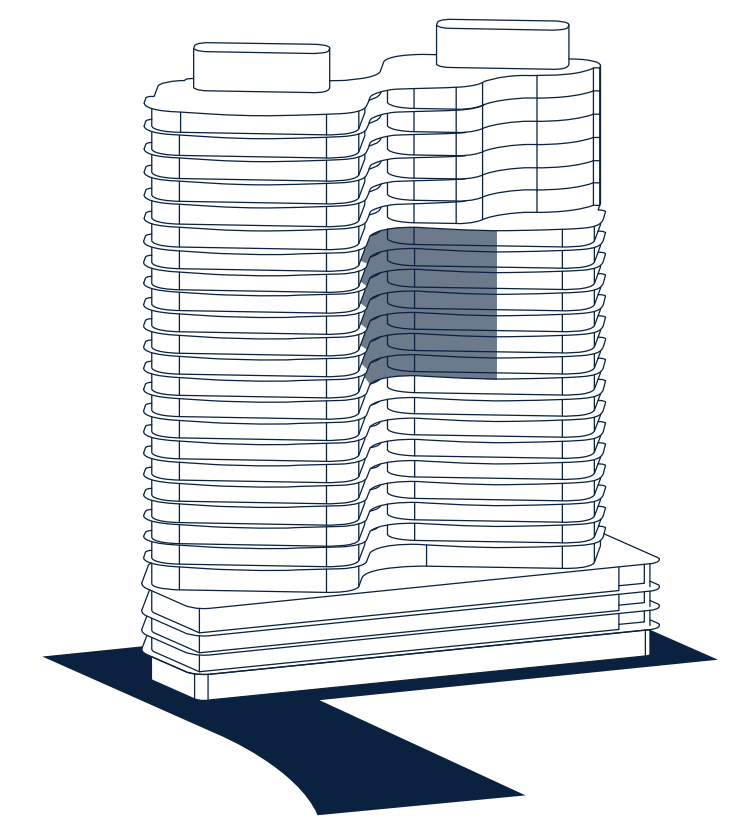

2785 NE 183RD STREET, AVENTURA FL 33160

Stated dimensions are measured to the exterior boundaries of the exterior walls and the centerline of interior demising walls and in fact vary from the dimensions that would be determined by using the description and definition of the "Unit" set forth in the Declaration (which generally only includes the interior airspace between the perimeter walls and excludes interior structural components). Note that measurements of rooms set forth on this floor plan are generally taken at the greatest points of each given room (as if the room were a perfect rectangle), without regard for any cutouts. Accordingly, the area of the actual room will typically).

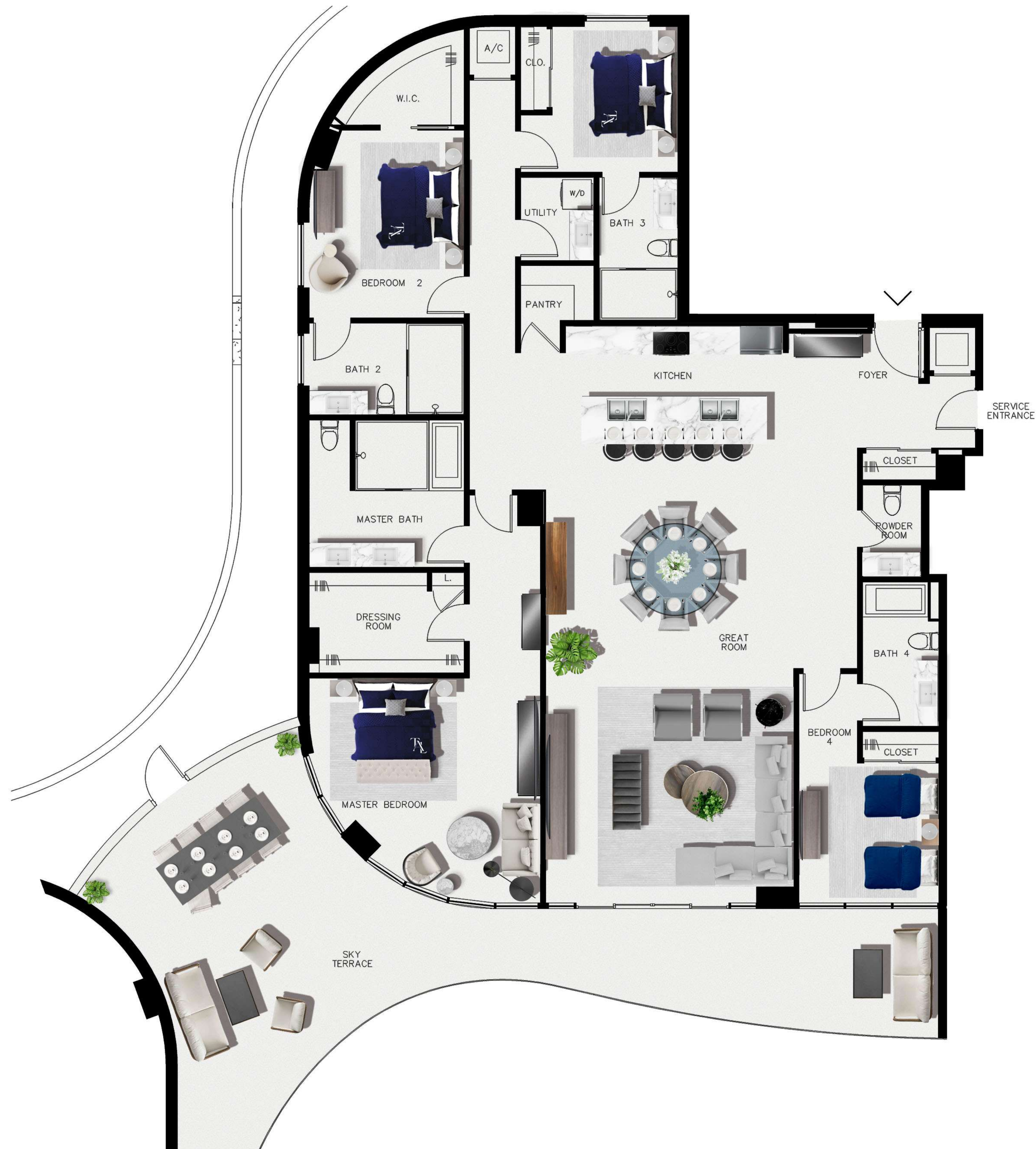



04
FLOOR 6 – 14
NORTH TOWER

2 BEDROOMS
2 BATHROOMS
POWDER ROOM

1,235 SQ. FT. INTERIOR
370 SQ. FT. EXTERIOR

10' CEILINGS
CUSTOM DESIGNED ITALKRAFT KITCHEN
BATHROOMS INCLUDES SPRAWLING
GLASS SHOWERS, NICHE WITH LIGHTING

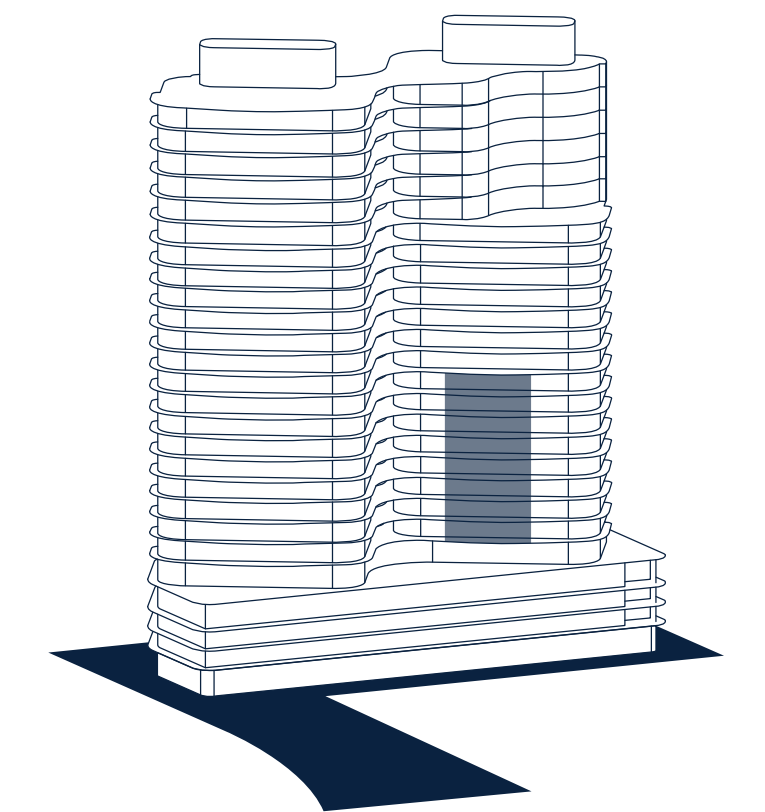

2785 NE 183RD STREET, AVENTURA FL 33160

Stated dimensions are measured to the exterior boundaries of the exterior walls and the centerline of interior demising walls and in fact vary from the dimensions that would be determined by using the description and definition of the "Unit" set forth in the Declaration (which generally only includes the interior airspace between the perimeter walls and excludes interior structural components). Note that measurements of rooms set forth on this floor plan are generally taken at the greatest points of each given room (as if the room were a perfect rectangle), without regard for any cutouts. Accordingly, the area of the actual room will typically).



05
FLOOR 6—14
NORTH TOWER

3 BEDROOMS
4 BATHROOMS
GAME ROOM
OFFICE/SERVICE QUARTERS
POWDER ROOM

2,460 SQ. FT. INTERIOR
355 SQ. FT. EXTERIOR

CORNER RESIDENCE 10' CEILINGS
CUSTOM DESIGNED ITALKRAFT KITCHEN
WITH 14 FT. ISLAND AND DOUBLE-SINKS
PRIMARY BATHROOM INCLUDES
SPRAWLING GLASS SHOWERS WITH
SOAKING TUB, NICHE WITH LIGHTING

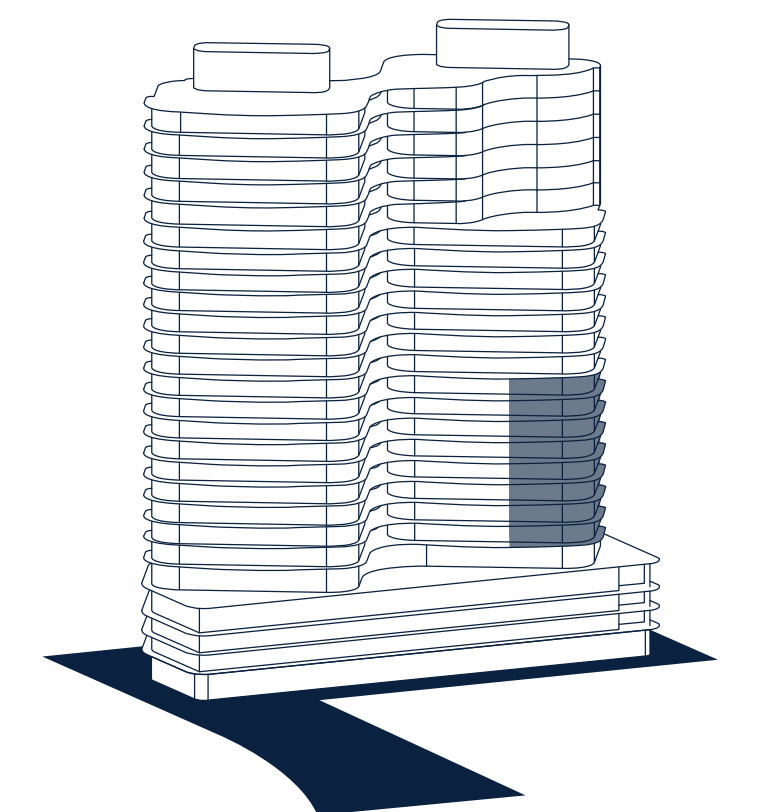

2785 NE 183RD STREET, AVENTURA FL 33160

Stated dimensions are measured to the exterior boundaries of the exterior walls and the centerline of interior demising walls and in fact vary from the dimensions that would be determined by using the description and definition of the "Unit" set forth in the Declaration (which generally only includes the interior airspace between the perimeter walls and excludes interior structural components). Note that measurements of rooms set forth on this floor plan are generally taken at the greatest points of each given room (as if the room were a perfect rectangle), without regard for any cutouts. Accordingly, the area of the actual room will typically).



O5
FLOOR 15 – 21
NORTH TOWER

4 BEDROOMS
5 BATHROOMS
POWDER ROOM
OFFICE/SERVICE QUARTERS
MEDIA ROOM

3,045 SQ. FT. INTERIOR
525 SQ. FT. EXTERIOR

CORNER RESIDENCE 10' CEILINGS
CUSTOM DESIGNED ITALKRAFT KITCHEN
WITH 14 FT. ISLAND AND DOUBLE-SINKS
PRIMARY BATHROOM INCLUDES
SPRAWLING GLASS SHOWERS WITH
SOAKING TUB, NICHE WITH LIGHTING

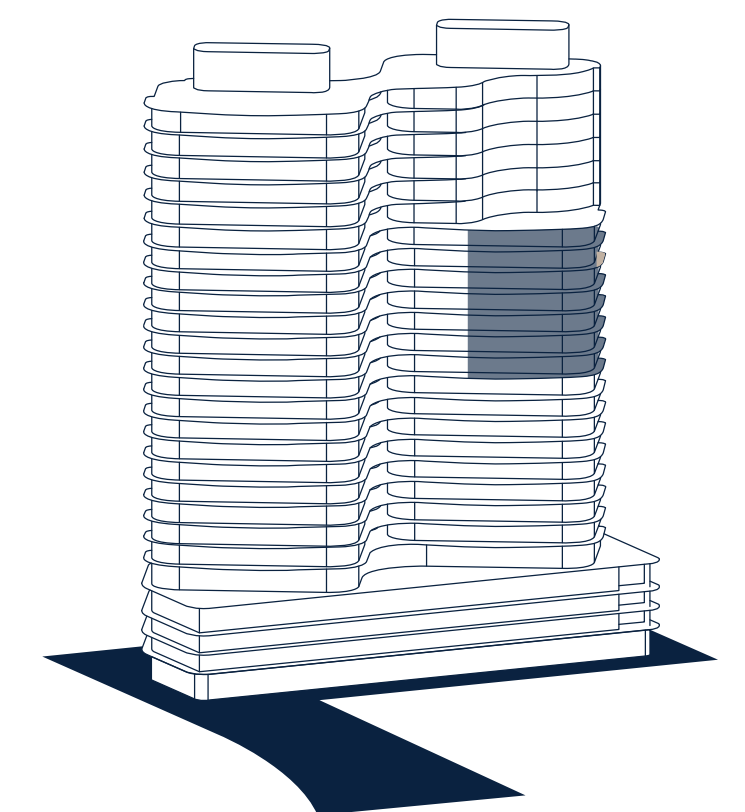

2785 NE 183RD STREET, AVENTURA FL 33160

Stated dimensions are measured to the exterior boundaries of the exterior walls and the centerline of interior demising walls and in fact vary from the dimensions that would be determined by using the description and definition of the "Unit" set forth in the Declaration (which generally only includes the interior airspace between the perimeter walls and excludes interior structural components). Note that measurements of rooms set forth on this floor plan are generally taken at the greatest points of each given room (as if the room were a perfect rectangle), without regard for any cutouts. Accordingly, the area of the actual room will typically).

THE VILLA RESIDENCE 501 FLOOR 5 SOUTH TOWER

5 BEDROOMS
5 BATHROOMS
POWDER ROOM

3,510 SQ. FT. INTERIOR
2,150 SQ. FT. EXTERIOR
PRIVATE OUTDOOR POOL

CORNER RESIDENCE 10' CEILINGS
CUSTOM DESIGNED ITALKRAFT KITCHEN
WITH 14 FT. ISLAND AND DOUBLE-SINKS
PRIMARY BATHROOM INCLUDES
SPRAWLING GLASS SHOWERS WITH
SOAKING TUB, NICHE WITH LIGHTING
SERVICE ENTRANCE

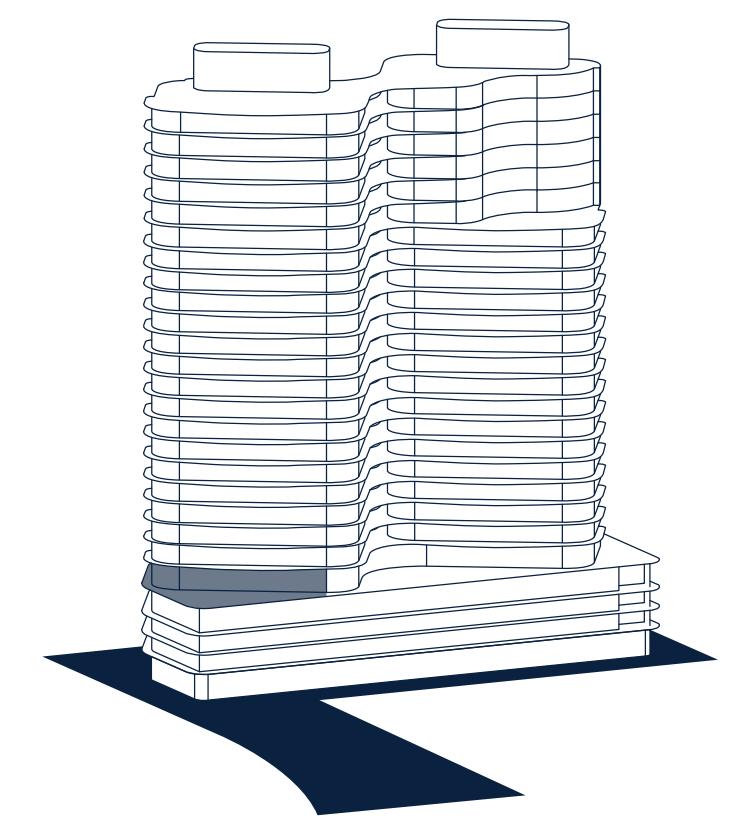

2785 NE 183RD STREET, AVENTURA FL 33160

Stated dimensions are measured to the exterior boundaries of the exterior walls and the centerline of interior demising walls and in fact vary from the dimensions that would be determined by using the description and definition of the "Unit" set forth in the Declaration (which generally only includes the interior airspace between the perimeter walls and excludes interior structural components). Note that measurements of rooms set forth on this floor plan are generally taken at the greatest points of each given room (as if the room were a perfect rectangle), without regard for any cutouts. Accordingly, the area of the actual room will typically).



SKY VILLA 1 FLOOR 22 NORTH TOWER

4 BEDROOMS
4 BATHROOMS
POWDER ROOM
BAR
SKY TERRACE
OVERSIZED LANAI

4,160 SQ. FT. INTERIOR
3120 SQ. FT. BALCONY

FULL FLOOR RESIDENCE 10' CEILINGS
CUSTOM DESIGNED ITALKRAFT KITCHEN
WITH 14 FT. ISLAND AND DOUBLE-SINKS
PRIMARY BATHROOM INCLUDES
SPRAWLING GLASS SHOWERS WITH
SOAKING TUB, NICHE WITH LIGHTING
SERVICE ENTRANCE

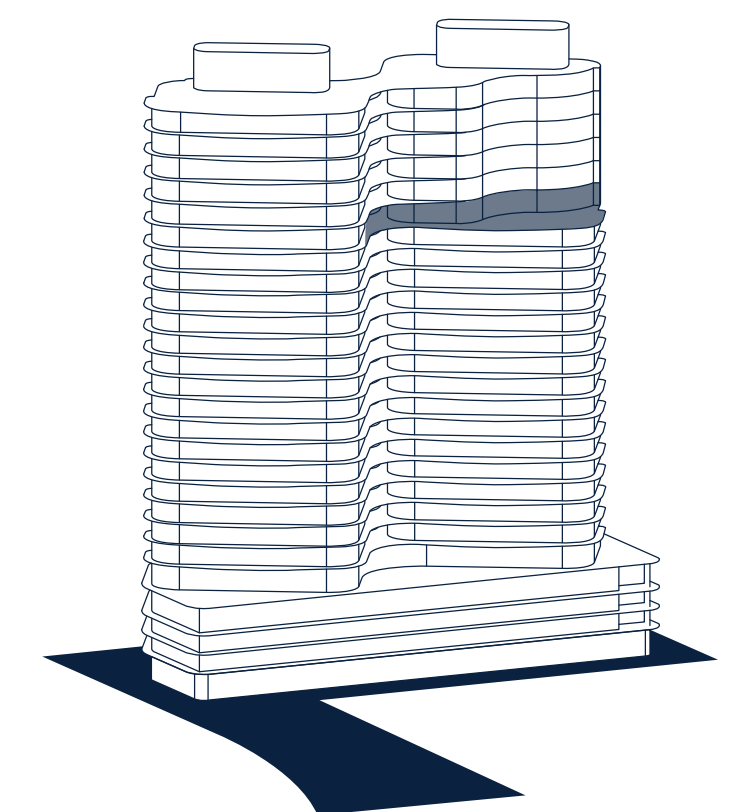

2785 NE 183RD STREET, AVENTURA FL 33160

Stated dimensions are measured to the exterior boundaries of the exterior walls and the centerline of interior demising walls and in fact vary from the dimensions that would be determined by using the description and definition of the "Unit" set forth in the Declaration (which generally only includes the interior airspace between the perimeter walls and excludes interior structural components). Note that measurements of rooms set forth on this floor plan are generally taken at the greatest points of each given room (as if the room were a perfect rectangle), without regard for any cutouts. Accordingly, the area of the actual room will typically).



SKY VILLA 2-5 FLOOR 23-26 NORTH TOWER

4 BEDROOMS
4 BATHROOMS
POWDER ROOM
BAR
SKY TERRACE

4,160 SQ. FT. INTERIOR
615 SQ. FT. EXTERIOR

FULL FLOOR RESIDENCE 10' CEILINGS
CUSTOM DESIGNED ITALKRAFT KITCHEN
WITH 14 FT. ISLAND AND DOUBLE-SINKS
PRIMARY BATHROOM INCLUDES
SPRAWLING GLASS SHOWERS WITH
SOAKING TUB, NICHE WITH LIGHTING
SERVICE ENTRANCE

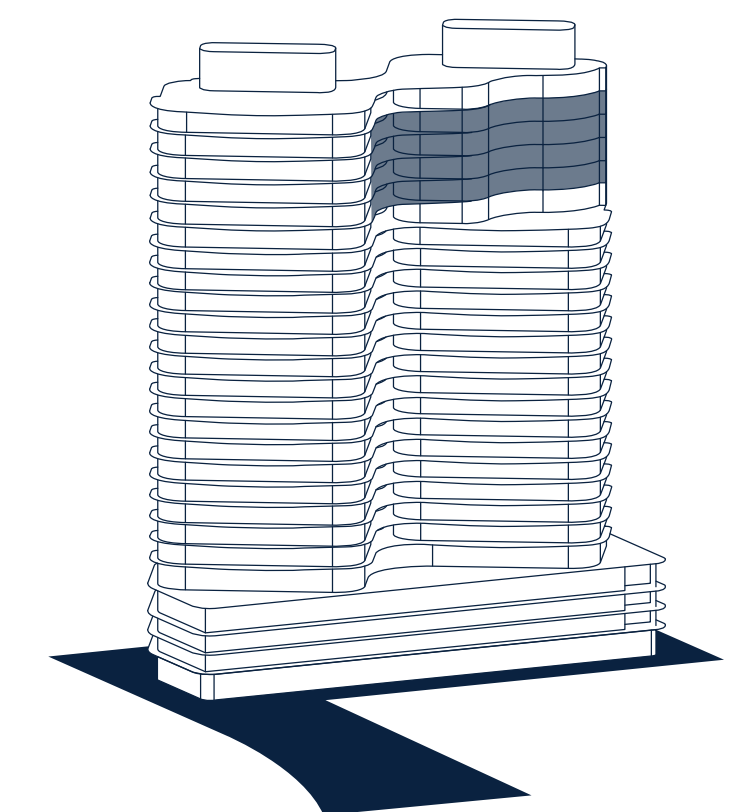

2785 NE 183RD STREET, AVENTURA FL 33160

Stated dimensions are measured to the exterior boundaries of the exterior walls and the centerline of interior demising walls and in fact vary from the dimensions that would be determined by using the description and definition of the "Unit" set forth in the Declaration (which generally only includes the interior airspace between the perimeter walls and excludes interior structural components). Note that measurements of rooms set forth on this floor plan are generally taken at the greatest points of each given room (as if the room were a perfect rectangle), without regard for any cutouts. Accordingly, the area of the actual room will typically).



UPH 01 FLOOR 27+ ROOFTOP SOUTH TOWER

5 BEDROOMS
5 BATHROOMS
POWDER ROOM
WINE CELLAR
ROOFTOP TERRACE

6,180 SQ. FT. INTERIOR
1010 SQ. FT. BALCONY
5715 SQ. FT. ROOF DECK

FULL FLOOR 10' CEILINGS
CUSTOM DESIGNED ITALKRAFT KITCHEN
WITH 14 FT. ISLAND AND DOUBLE-SINKS
PRIMARY BATHROOM INCLUDES
SPRAWLING GLASS SHOWERS WITH
SOAKING TUB, NICHE WITH LIGHTING
SERVICE ENTRANCE

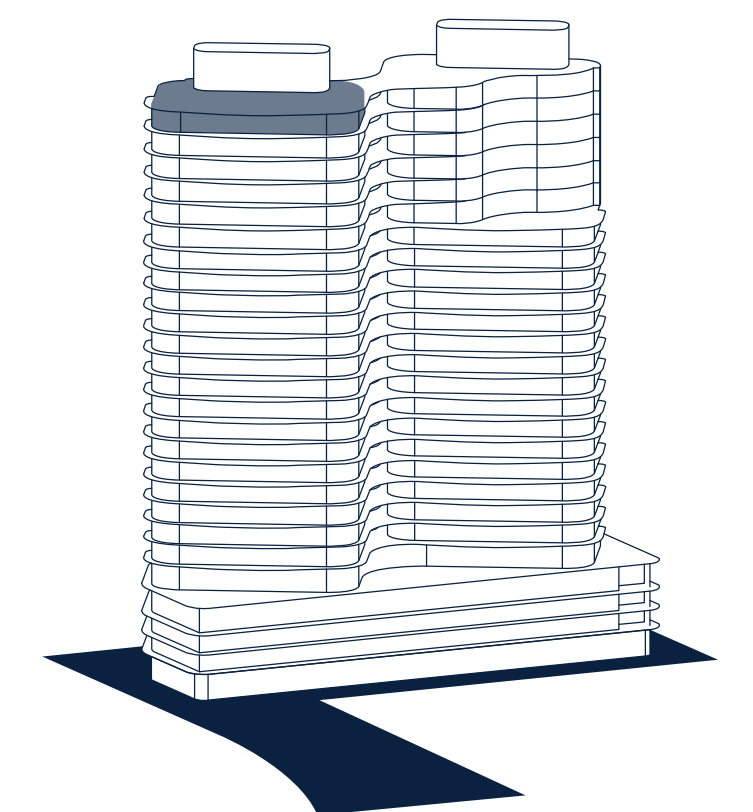

2785 NE 183RD STREET, AVENTURA FL 33160

Stated dimensions are measured to the exterior boundaries of the exterior walls and the centerline of interior demising walls and in fact vary from the dimensions that would be determined by using the description and definition of the "Unit" set forth in the Declaration (which generally only includes the interior airspace between the perimeter walls and excludes interior structural components). Note that measurements of rooms set forth on this floor plan are generally taken at the greatest points of each given room (as if the room were a perfect rectangle), without regard for any cutouts. Accordingly, the area of the actual room will typically).



UPH 02 FLOOR 27 + ROOFTOP NORTH TOWER

4 BEDROOMS
4 BATHROOMS
POWDER ROOM
BAR
SKY TERRACE
ROOFTOP TERRACE

4,150 SQ. FT. INTERIOR
615 SQ. FT. SKY TERRACE
3040 SQ. FT. ROOF DECK

FULL FLOOR RESIDENCE 10' CEILINGS
CUSTOM DESIGNED ITALKRAFT KITCHEN
WITH 14 FT. ISLAND AND DOUBLE-SINKS
PRIMARY BATHROOM INCLUDES
SPRAWLING GLASS SHOWERS WITH
SOAKING TUB, NICHE WITH LIGHTING
SERVICE ENTRANCE

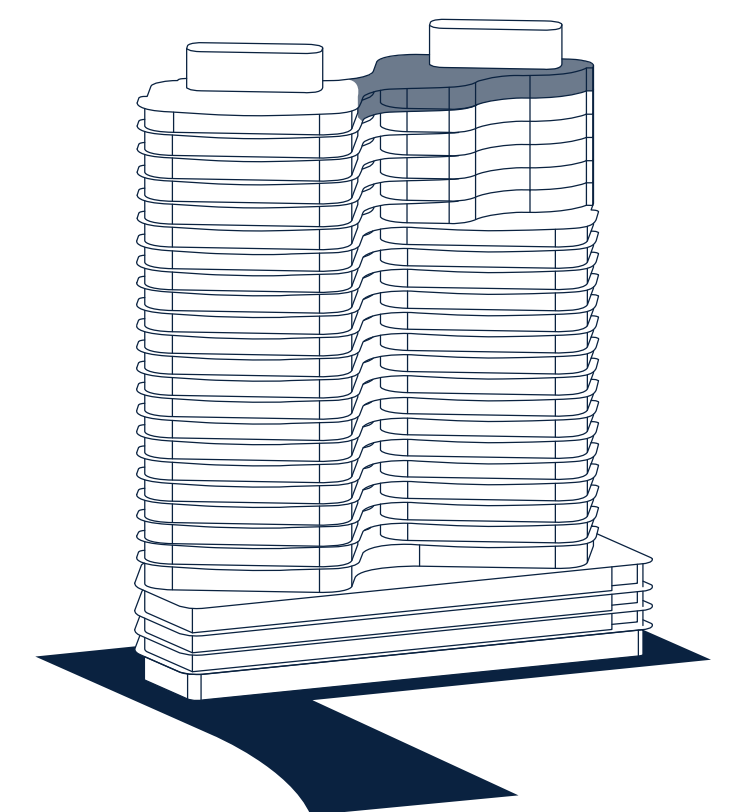

2785 NE 183RD STREET, AVENTURA FL 33160

Stated dimensions are measured to the exterior boundaries of the exterior walls and the centerline of interior demising walls and in fact vary from the dimensions that would be determined by using the description and definition of the "Unit" set forth in the Declaration (which generally only includes the interior airspace between the perimeter walls and excludes interior structural components). Note that measurements of rooms set forth on this floor plan are generally taken at the greatest points of each given room (as if the room were a perfect rectangle), without regard for any cutouts. Accordingly, the area of the actual room will typically).

