

MARINA POINTE

WESTSHORE MARINA DISTRICT

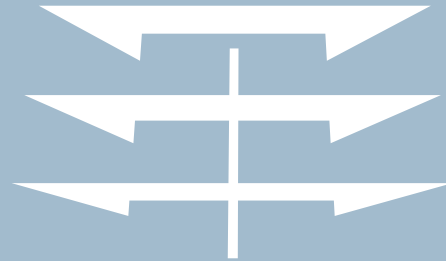

Introducing
Tower Two

LIFE IS BETTER LIVED ON THE WATER

Welcome to a new life on the water. Relaxed, laidback coastal oasis by day.
Gateway to Tampa Bay's rich cultural heritage by night.

Marina Pointe is where luxury meets carefree comfort. Set sail and cruise through lush mangroves and shimmering waves.
With adventure and new experiences at every turn, the peninsula is all yours to discover.

Community features, amenities and pricing are approximate and subject to change without notice. Developer reserves the right to replace with items of equal value. There are various methods for calculating the total square footage of a condominium unit, and depending on the method of calculation, the quoted square footage of a condominium unit may vary by more than a nominal amount. The dimensions stated in this brochure are measured to the exterior boundaries of the exterior walls and the centerline of interior demising walls and, in fact, are larger than the dimensions of the "Unit" as defined in the Declaration of Condominium for Marina Pointe which is measured using interior measurements. All illustrations are artistic conceptual renderings. The property does not come fully furnished. Residences will be delivered with closets designer ready. Broker participation welcomed. Prices and availability are subject to change at any time without notice.

ORAL REPRESENTATIONS CANNOT BE RELIED UPON AS CORRECTLY STATING REPRESENTATIONS OF THE DEVELOPER. FOR CORRECT REPRESENTATIONS, MAKE REFERENCE TO THIS BROCHURE AND TO THE DOCUMENTS REQUIRED BY SECTION 718.503, FLORIDA STATUTES, TO BE FURNISHED BY A DEVELOPER TO A BUYER OR LESSEE.

MARINA POINTE

CONTEMPORARY LIVING

Distinctive architecture. Elegant interiors.
Cutting-edge features.

Simple sophistication inspired by coastal living in the heart of Tampa Bay.



Sketches and illustrations are artist's renderings. Details and field variations are subject to change. All dimensions are approximate and all floor plans and development plans are subject to change.

WESTSHORE MARINA DISTRICT

LARGEST AND MOST IMPRESSIVE

1. Marina Pointe Waterfront Condominiums
2. Marina Pointe Deepwater Marina
3. Sunset Park
4. Guest Dock
5. Potential for Waterfront Restaurant & Bar
6. Community Grand Entrance
7. Sales Center & Potential Future Retail
8. The Town by Related
9. WCI Luxury Townhomes
10. Town Center with Market, Café and Retail
11. District Rotunda with Art Installation
12. Conservation Pond with Jogging Trails
13. Bainbridge at Westshore Marina District
14. Grand Entrance to Marina Pointe
15. Park Promenade

WESTSHORE MARINA DISTRICT

The Westshore Marina District is a stunning new master-planned community overlooking one of the largest and most impressive yacht basins on Tampa Bay. Situated along 1.5 scenic miles of waterfront, green space, marina and open bay, this all-new, 52-acre destination presents a fresh, contemporary environment for water-inspired living, shopping, dining and recreation.

- Beautiful waterfront parks and trails, perfect for walking, jogging and recreational activities

- Potential waterfront restaurant and bar overlooking the marina, where residents can stroll in and enjoy meals on the water and boat owners can “dock and dine”

- Marina Landings town center including retailers such as Duckweed Urban Grocery, Cru Cellars, Salon Color Bar, Crave Spa, Sand Surf Company, DRNK Coffee & Tea, Buzzed Bull Creamery, Chuck Lager America's Tavern and QWENCH juice bar

- Private, deep-water marina with 149 slips accommodating vessels up to 90 feet



WESTSHORE
MARINA DISTRICT



AN IDEAL CENTRAL LOCATION

Westshore Marina District is ideally located in the heart of Tampa Bay at the intersection of Gandy Boulevard and Westshore Boulevard, major thoroughfares providing direct access to the vibrant nightlife, dining and culture of downtown Tampa just 6 miles east and downtown St. Petersburg 10 miles west.

The prestigious South Tampa location is also convenient to the city's finest shopping, dining and entertainment. Westshore Plaza, International Plaza, Hyde Park Village, The Florida Aquarium, Amalie Arena, and the National Historic Landmark District of Ybor City are all within 10 to 15 minutes of home.

Entitled for over 1,300 residential units within the district including:

- Town Westshore Apartments by The Related Group (396 Units)
- Bainbridge at Westshore Marina District Apartments (351 Units)
- Luxury Townhomes by WCI Communities (160 Units)
- Marina Pointe luxury condominium towers by BTI Partners (350+ Units)
- 159+ slip marina with transient dockage for visitors

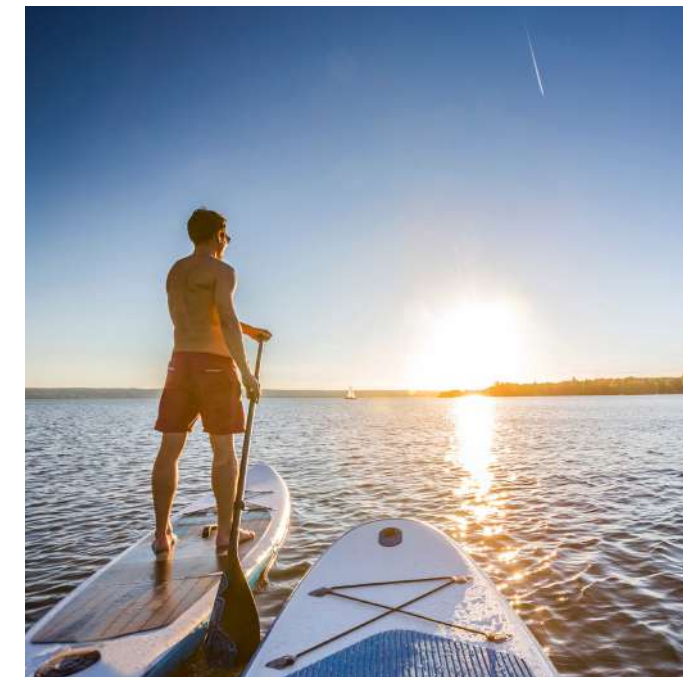

WELCOME TO TAMPA BAY

With its mix of historic architecture and modern landmarks, a culture infused with Cuban and Spanish flavors, vibrant business districts, and beautiful waterways, Tampa is a wonderful place to work, play and unwind. It's the third largest city in the state of Florida - right after Miami and Orlando - with its own cruise and cargo port, and the Tampa International Airport offers nonstop flights to more than 90 destinations throughout North America, Central America, the Caribbean and Europe.

From historic Ybor City to elegant Hyde Park, Tampa is overflowing with culture, excitement and adventure. Every year, millions of visitors fly, drive or cruise here to try the rollercoasters and waterslides at Busch Gardens and Adventure Island; cheer on professional baseball, soccer, football and hockey teams; and experience the thrill of the Gasparilla Pirate Festival, which features a "real" pirate invasion.

The destination's popularity is spreading far and wide as residents and tourists discover more of its fascinating arts and culture, lively nightlife, innovative restaurants, and outdoor adventures.

Tampa is also home to two major universities - the University of Tampa and the University of South Florida - and is just a short drive away from the beloved beaches of St. Petersburg and Clearwater! Even Orlando's world-famous Walt Disney World Resort is less than 70 miles east of the city via I-4, and Floridian destinations such as Miami and Key West can be reached by car or via direct flights from Tampa International Airport.



THE GREATER TAMPA BAY AREA

Tampa Bay is a large natural harbor and shallow estuary connected to the Gulf of Mexico on the west-central coast of Florida.

AIRPORTS

- 1. Tampa International Airport, 7.6 miles
- 2. St. Pete–Clearwater Int. Airport, 12.3 miles

UNIVERSITIES

- 3. University of Tampa, 6.6 miles
- 4. University of South Florida, 17.5 miles

SHOPPING

- 5. Westshore Plaza, 4.7 miles
- 6. Hyde Park Village, 7.0 miles
- 7. International Plaza & Bay Street, 6.0 miles

ENTERTAINMENT

- 8. Busch Gardens, 16.0 miles
- 9. The Florida Aquarium, 8.5 miles
- 10. Ybor City, 10.4 miles
- 11. Bayshore Boulevard, 3.8 miles
- 12. The Dalí Museum, 17.5 miles
- 13. Walt Disney World®, 75.2 miles

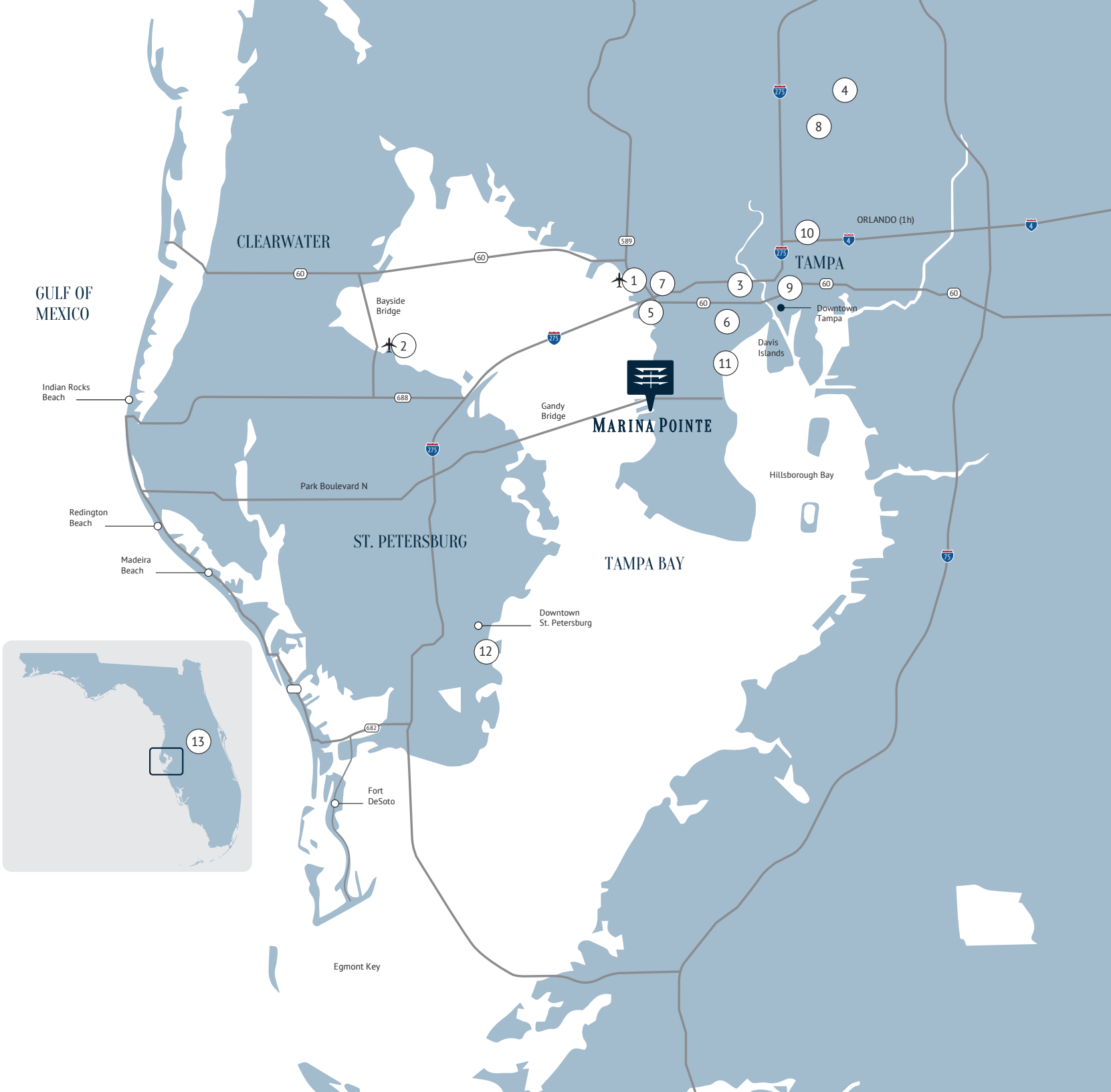

EVERY DAY CAN START AND END

Panoramic views of shimmering blue water. Modern, contemporary architecture.
We've combined the best of our first tower with the very latest designs in Tower Two.

BEAUTIFULLY

It's the little details that let you live your way at Marina Pointe.
Enjoy our luxurious waterfront lifestyle that puts the water at the heart of our community.

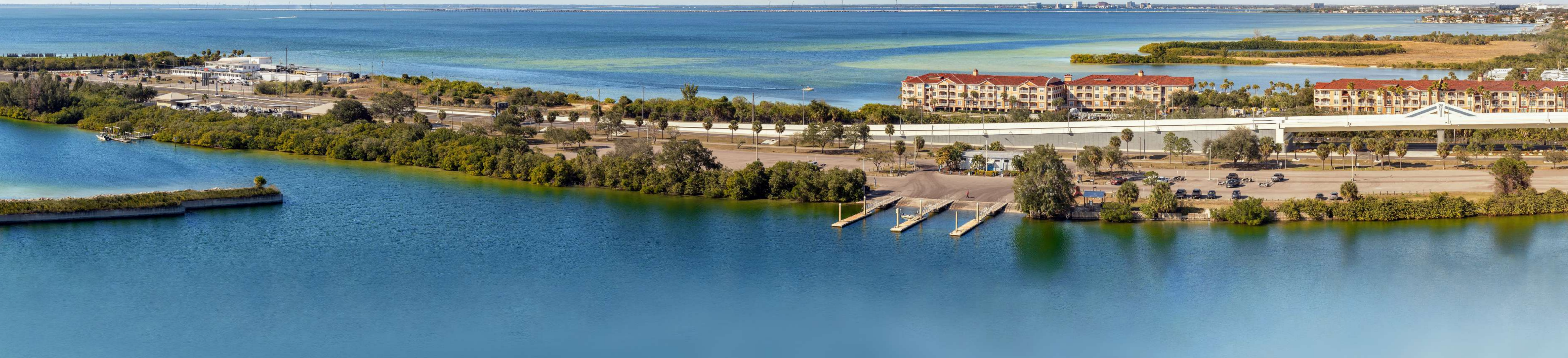

Discover Life on Peninsula. All Views Celebrate the Best Moment to Enjoy.

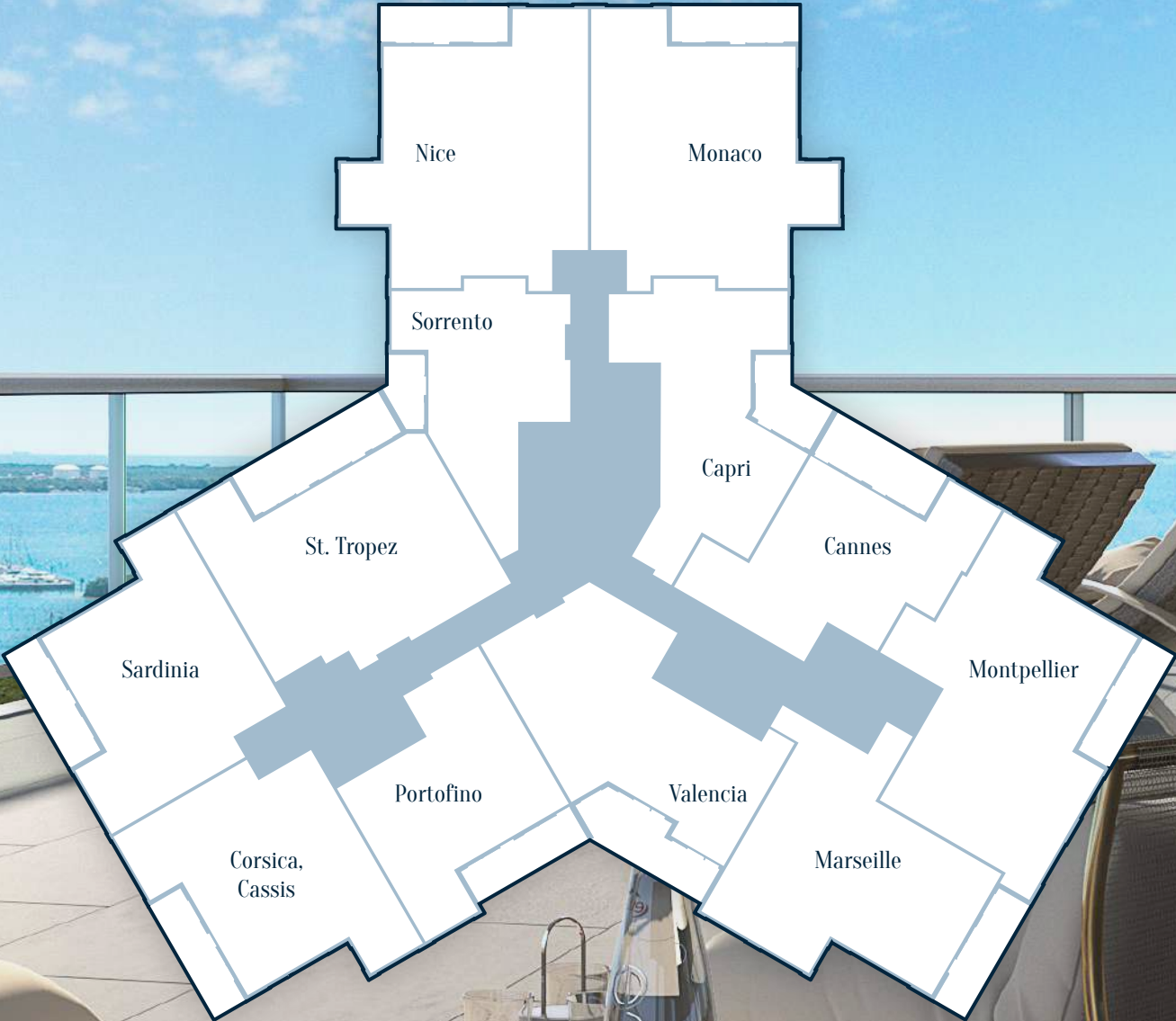

Explore 360° views from Tower One

MARINA POINTE AMENITIES

Tower One and Tower Two shared amenities

INDOOR

- Dramatic vaulted entry lobby
- Reception desk staffed by 24/7 concierge
- Business room with conference desk
- Virtual golf simulator
- Residents' Social Room: Bar and large screen TV; Private dining and entertaining room
- Wellness center with state-of-the-art cardio and strength equipment
- Multipurpose training room
- Outdoor yoga area with zen garden
- Men and women steam room
- Private massage studio
- Mailroom and secured package storage
- Secured personal storage
- Two luxury guest suites available
- Bicycle storage

PARKING & SECURITY

- Secured and covered parking spaces within the garage
- Gated entrance
- Resident fob access to elevator

MARINA

- Deep water slips ranging to accommodate yachts up to 90'
- Dockmaster
- Pumpout station
- Power and water
- Wide loading docks

OUTDOOR

- Oversized, heated resort-style pools overlooking Old Tampa Bay
- Abundant, lush landscaping
- Secluded heated spa
- Built-in day beds under trellis and shade trees
- Gas grills under trellis
- Bocce court
- Secured off-leash dog park with pet-friendly turf
- Landscaped trails with access to park and waterfront

Sketches and illustrations are artist's renderings. Details and field variations are subject to change. All dimensions are approximate and all floor plans and development plans are subject to change.



RESIDENCE FEATURES

DESIGN

- Contemporary flow-through floorplans
- High ceiling heights in bedrooms and great rooms
- Floor-to-ceiling glass walls and windows in many areas
- Open and expansive entertainment spaces
- Energy-efficient, high-impact windows and sliding glass doors
- Oversized balconies provide additional space for year-round outdoor living
- Oversized, designer-ready walk-in closets
- Energy-efficient air conditioning system
- Solid entry doors
- Integrated fire protection system with ceiling-mounted sprinkler heads
- Recessed accent lighting in kitchens and baths

GOURMET KITCHEN

CABINETS

- European-style cabinetry with soft-close hinges
- Waterfall-edge quartz countertops

APPLIANCES

- Premium, built-in refrigerator/freezer
- Top-of-the-line cooktop with stainless steel hood
- Stainless steel microwave and wall-mounted oven

FIXTURES

- Premium fixtures and appointments
- Pre-wired for lights in great room, bedrooms and dining area

PREMIUM FLOORING

- Porcelain tile all in bathrooms
- Plush, wall-to-wall carpeting in bedrooms

BATHROOMS

- Premium bath fixtures and appointments
- European-style cabinetry
- Under-mount sinks
- Large walk-in showers
- Large Owner's Suite walk-in closets

LAUNDRY

- Large-capacity washer and dryer

ST. TROPEZ

3 BEDS • 3 BATHS + DEN

Air Conditioned: 1,727 sq. ft.
Terrace: 290 sq. ft.
Total Living Space: 2,017 sq. ft.

Floors 5 - 16

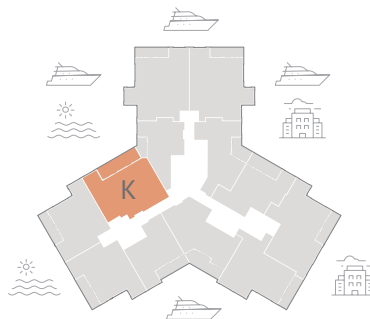

MONTPELLIER

3 BEDS • 3.5 BATHS

Air Conditioned: 2,027 sq. ft.
Terrace: 171 sq. ft.
Total Living Space: 2,198 sq. ft.

Floors 5 - 16

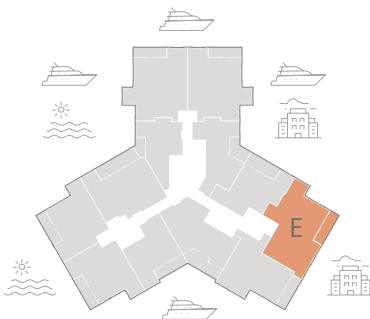
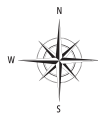

NICE

3 BEDS • 3 BATHS

Air Conditioned: 1,961 sq. ft.
Terrace: 169 sq. ft.
Total Living Space: 2,130 sq. ft.

Floors 6 - 16

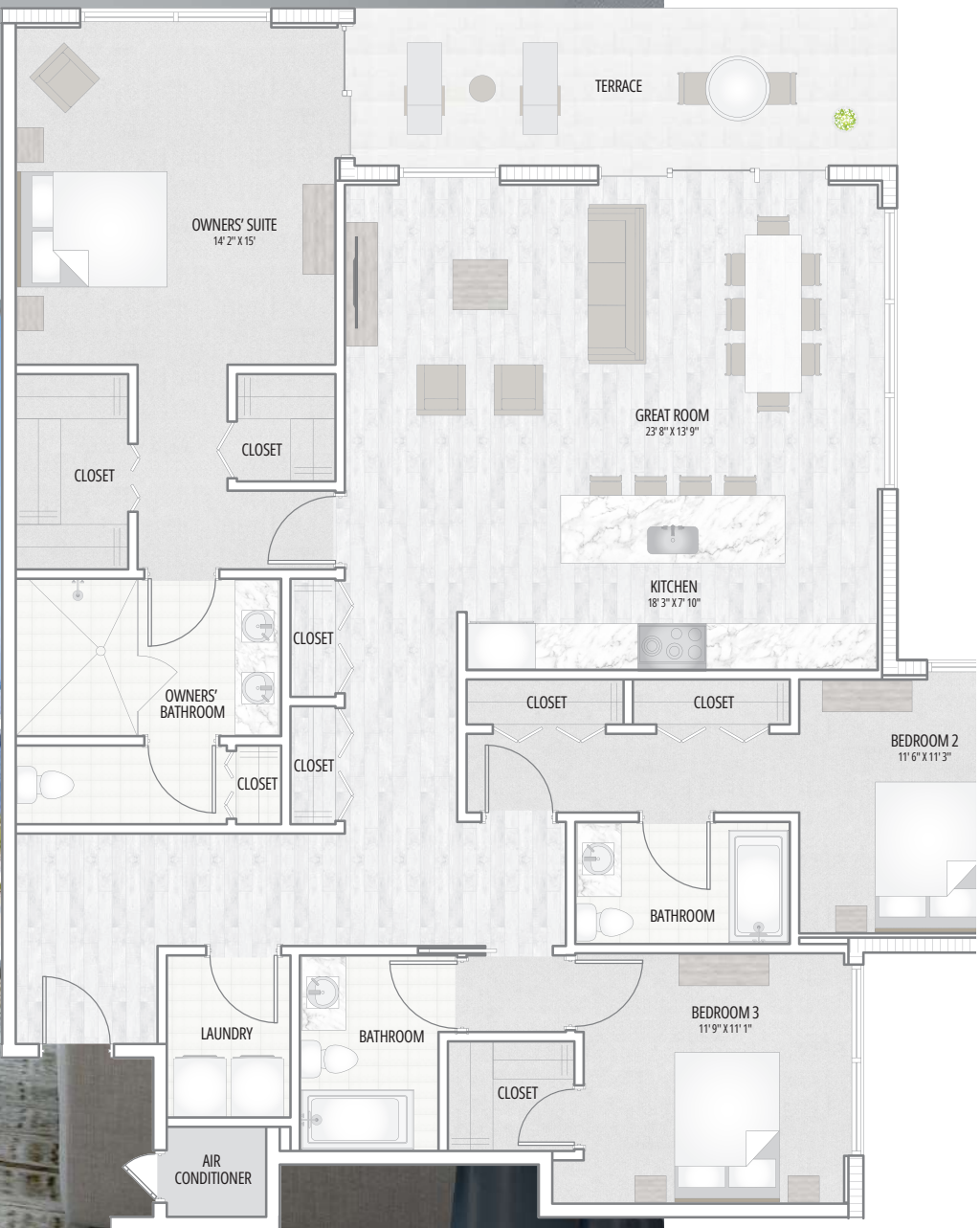
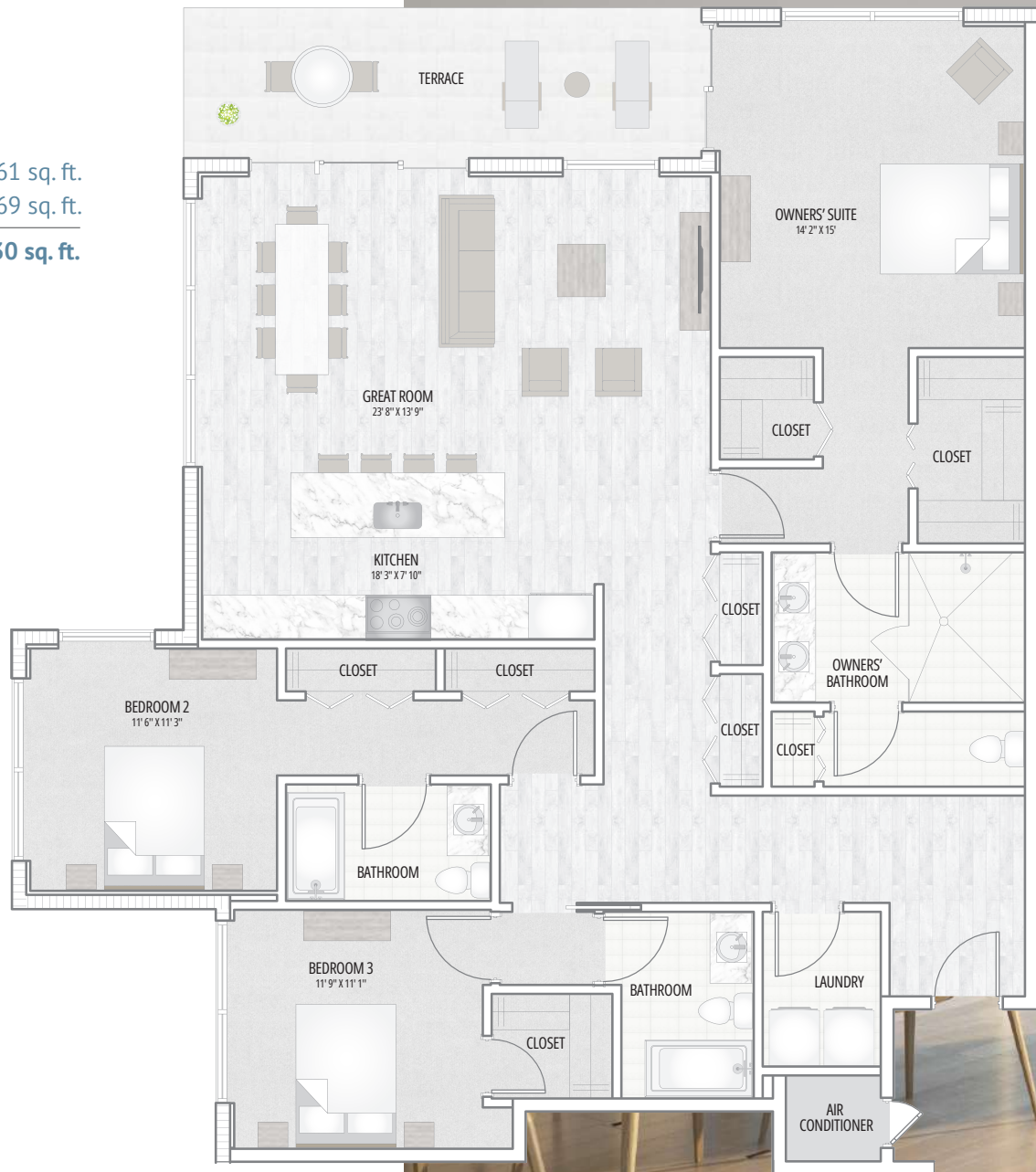
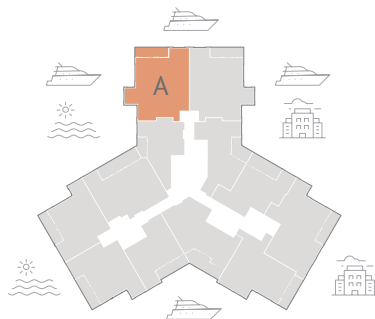
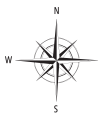

MONACO

3 BEDS • 3 BATHS

Air Conditioned: 1,961 sq. ft.
Terrace: 169 sq. ft.
Total Living Space: 2,130 sq. ft.

Floors 6 - 16

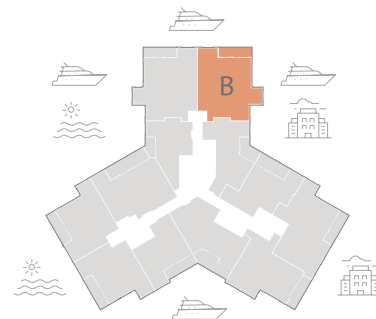
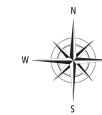

Sketches and illustrations are artist's renderings. Details and field variations are subject to change.
All dimensions are approximate and all floor plans and development plans are subject to change.

NICE SALON

2 BEDS • 2.5 BATHS + DEN

Air Conditioned: 1,989 sq. ft.
Terrace: 169 sq. ft.
Total Living Space: 2,158 sq. ft.

Floors 2 - 5

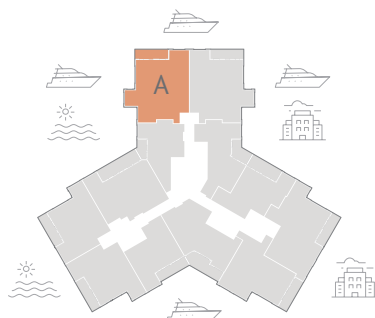

MONACO SALON

2 BEDS • 2.5 BATHS + DEN

Air Conditioned: 1,989 sq. ft.
Terrace: 169 sq. ft.
Total Living Space: 2,158 sq. ft.

Floors 2 - 5

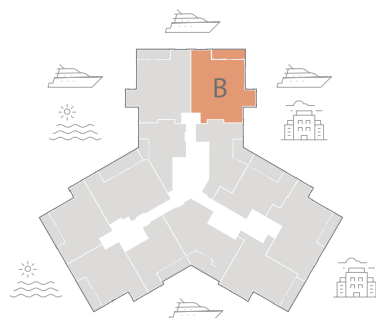
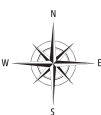

Sketches and illustrations are artist's renderings. Details and field variations are subject to change.
All dimensions are approximate and all floor plans and development plans are subject to change.

CORSICA

2 BEDS • 2.5 BATHS

Air Conditioned: 1,523 sq. ft.
Terrace: 171 sq. ft.
Total Living Space: 1,694 sq. ft.

Floors 5 - 16

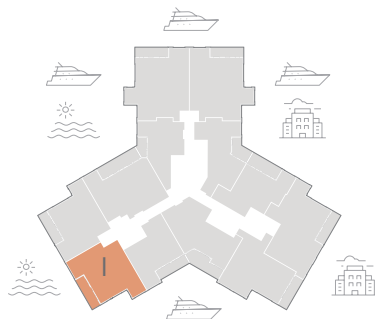
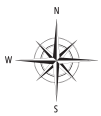

SARDINIA

2 BEDS • 2.5 BATHS

Air Conditioned: 1,523 sq. ft.
Terrace: 171 sq. ft.
Total Living Space: 1,694 sq. ft.

Floors 5 - 16

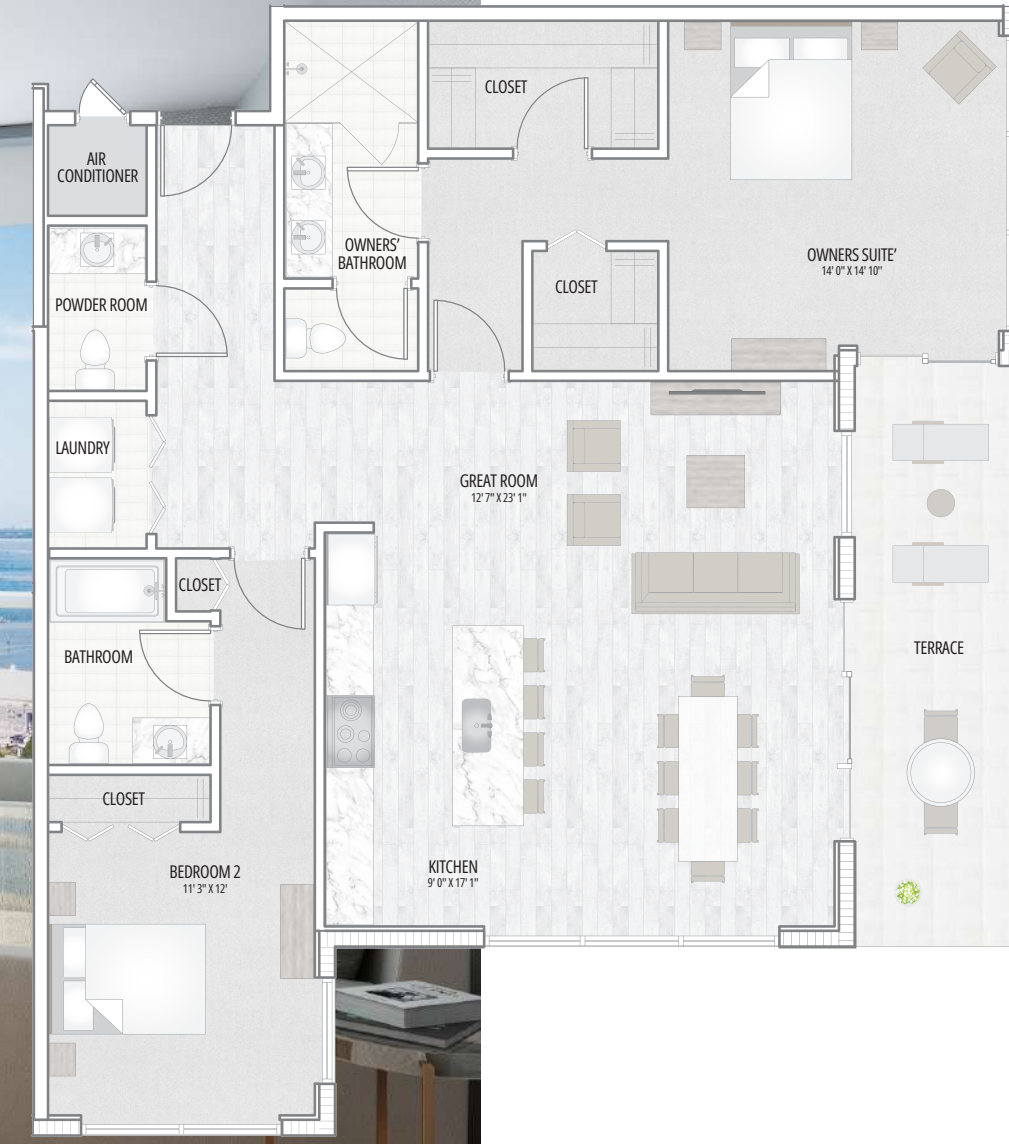
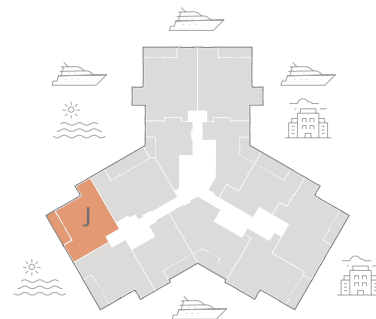
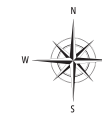

MARSEILLE

2 BEDS • 2.5 BATHS

Air Conditioned: 1,668 sq. ft.
Terrace: 171 sq. ft.
Total Living Space: 1,839 sq. ft.

Floors 2 - 16

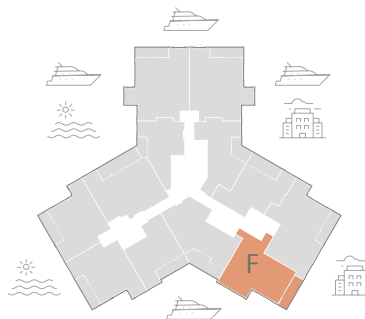
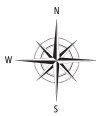

Sketches and illustrations are artist's renderings. Details and field variations are subject to change. All dimensions are approximate and all floor plans and development plans are subject to change.

VALENCIA

2 BEDS • 2 BATHS

Air Conditioned: 1,544 sq. ft.
Terrace: 271 sq. ft.
Total Living Space: 1,815 sq. ft.

Floors 2 - 16

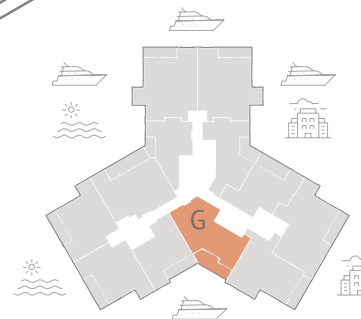
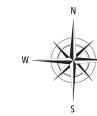

PORTOFINO

2 BEDS • 2 BATHS

Air Conditioned: 1,215 sq. ft.
Terrace: 170 sq. ft.
Total Living Space: 1,385 sq. ft.

Floors 2 - 16

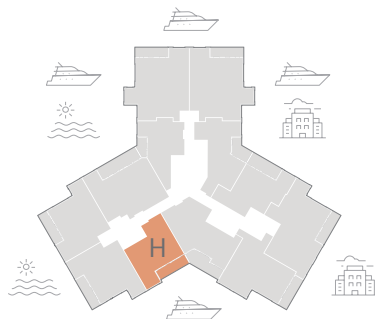
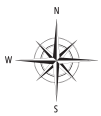

Sketches and illustrations are artist's renderings. Details and field variations are subject to change.
All dimensions are approximate and all floor plans and development plans are subject to change.

CAPRI

2 BEDS • 2 BATHS

Air Conditioned: 1,323 sq. ft.
Terrace: 160 sq. ft.
Total Living Space: 1,483 sq. ft.

Floors 6 - 16

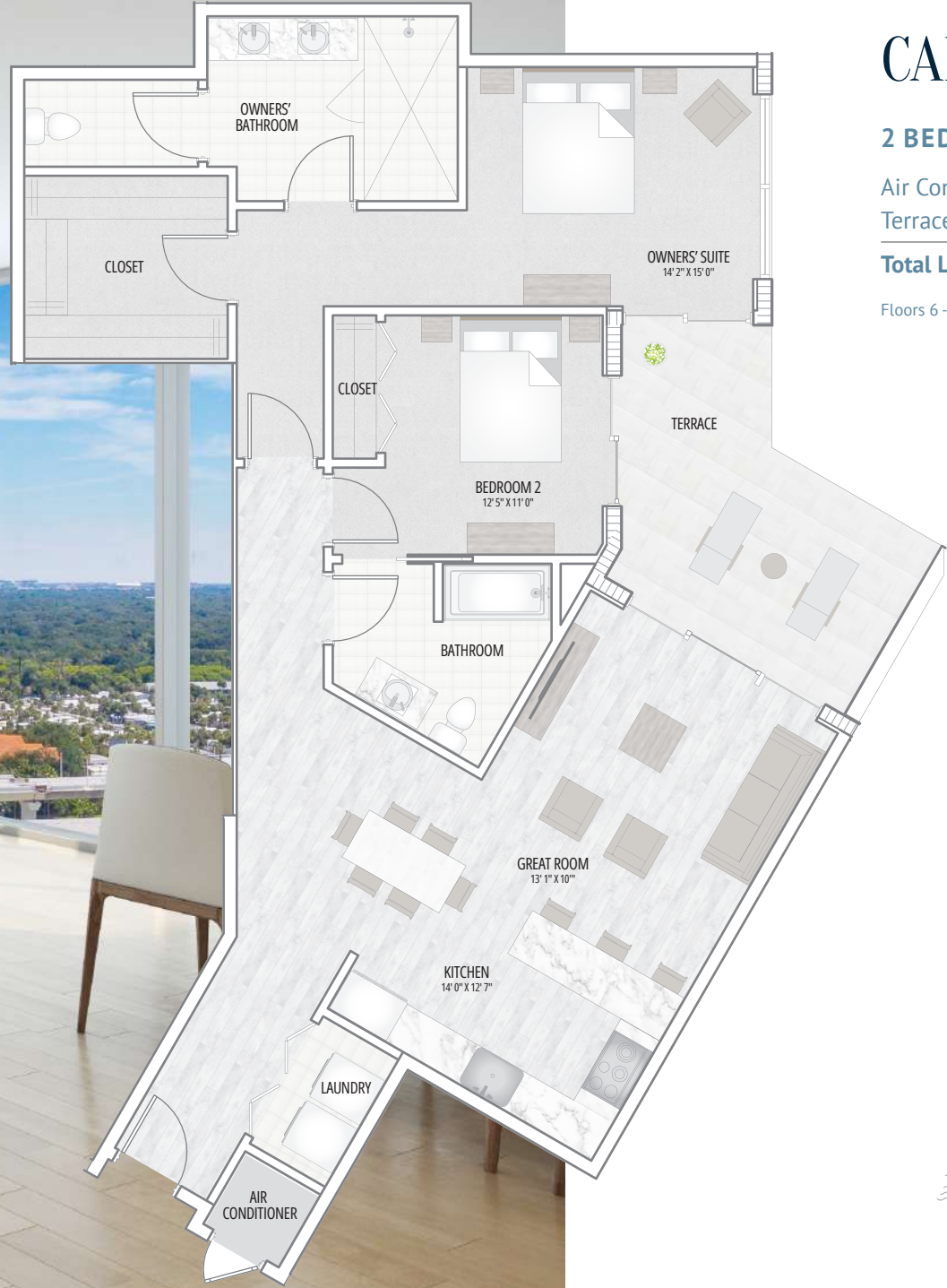
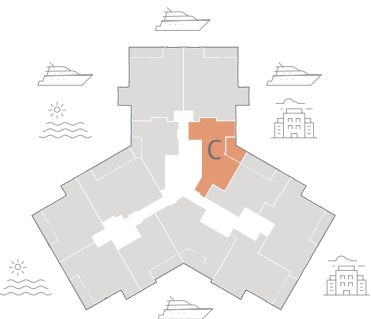
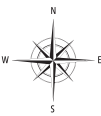

CANNES

2 BEDS • 2 BATHS

Air Conditioned: 1,295 sq. ft.

Terrace: 219 sq. ft.

Total Living Space: 1,514 sq. ft.

Floors 5 - 16

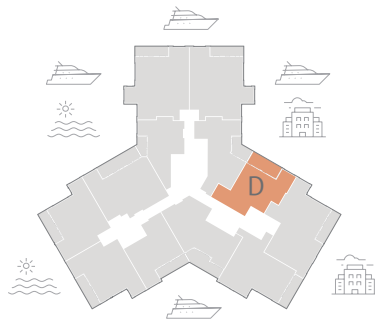
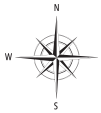

CASSIS

1 BED • 1.5 BATHS + DEN

Air Conditioned: 1,419 sq. ft.

Terrace: 196 sq. ft.

Total Living Space: 1,615 sq. ft.

Floors 2 - 4

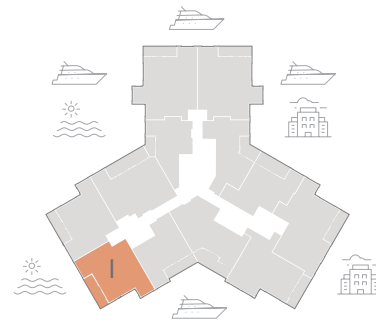
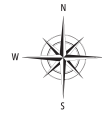

Sketches and illustrations are artist's renderings. Details and field variations are subject to change. All dimensions are approximate and all floor plans and development plans are subject to change.

SORRENTO

1 BED • 1.5 BATHS

Air Conditioned: 1,133 sq. ft.

Terrace: 92 sq. ft.

Total Living Space: 1,225 sq. ft.

Floors 6 - 16

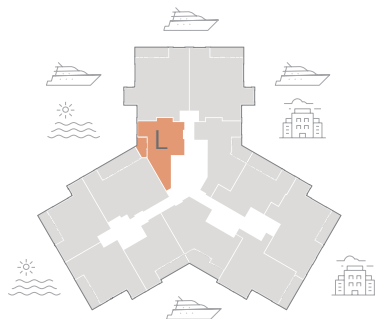
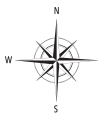

Sketches and illustrations are artist's renderings. Details and field variations are subject to change. All dimensions are approximate and all floor plans and development plans are subject to change.

BTI Partners is One of Florida’s Leading Real Estate and Land Developers

BTI Partners is reshaping cities across Florida by master-planning vibrant mixed-use communities, building luxury residential projects, reactivating marinas, and revitalizing neighborhoods with highly amenitized commercial and residential developments. Core values of integrity, passion, excellence, selflessness and purpose are central to the company’s ethos. Its successful track record has established BTI Partners as an industry leader in creating urban enclaves that attract and sustain local business and family life.

By seamlessly integrating residential, commercial, retail, hospitality, entertainment, education and recreational uses, BTI Partners designs highly desirable “live, work, play” communities to meet the needs of today and tomorrow. Looking to the future, BTI Partners remains ever mindful of evolving trends and continues to seek opportunities to develop transformational and inspirational mixed-use projects throughout the Sunbelt states.



The Grove Resort & Water Park Orlando is an expansive 106-acre hotel destination located just six miles from Walt Disney World® Theme Parks, with free transportation to Walt Disney World® Ticket and Transportation Center. Set on Lake Austin and amid a portion of Central Florida’s conservation grounds, The Grove is a sanctuary from the boisterous pace of the outside world.



\$3.6 billion
Real Estate Transactions

12,000 acres
Acquired or Controlled

18,000 units
Sold or Developed

5,000+ units
Under Construction

BTIPartners.com



MARINA POINTE

WESTSHORE MARINA DISTRICT

SALES GALLERY OPEN DAILY

4900 Bridge Street, Tampa, Florida 33611

Monday - Saturday: 10:00 am - 5:00 pm • Sunday: 12:00 pm - 5:00 pm

Call to schedule a presentation.

+1 (813) 930-9800 • info@marinapointe.com • MarinaPointe.com



BTIPartners.com

Community features, amenities and pricing are approximate and subject to change without notice. Developer reserves the right to replace with items of equal value. There are various methods for calculating the total square footage of a condominium unit, and depending on the method of calculation, the quoted square footage of a condominium unit may vary by more than a nominal amount. The dimensions stated in this brochure are measured to the exterior boundaries of the exterior walls and the centerline of interior demising walls and, in fact, are larger than the dimensions of the "Unit" as defined in the Declaration of Condominium for Marina Pointe which is measured using interior measurements. All illustrations are artistic conceptual renderings. The property does not come fully furnished. Residences will be delivered with closets designer ready. Broker participation welcomed. This is not an offer to sell or solicitation of offers to buy the condominium units in states where such offer or solicitation cannot be made. Prices and availability are subject to change at any time without notice.

ORAL REPRESENTATIONS CANNOT BE RELIED UPON AS CORRECTLY STATING REPRESENTATIONS OF THE DEVELOPER. FOR CORRECT REPRESENTATIONS, MAKE REFERENCE TO THIS BROCHURE AND TO THE DOCUMENTS REQUIRED BY SECTION 718.503, FLORIDA STATUTES, TO BE FURNISHED BY A DEVELOPER TO A BUYER OR LESSEE.

